

FISHER & PAYKEL

ACTIVSMART™ INTEGRATED REFRIGERATOR

FRAMED CABINETRY

RS9120W Models

INSTALLATION GUIDE

NZ AU GB IE HK SG IN

846806 A 07.17

FOLLOW THE INSTALLATION SEQUENCE RELEVANT TO YOUR CABINETRY

NOTE: PRODUCT IS DESIGNED FOR INTEGRATED INSTALLATION ONLY

FISHER & PAYKEL: RS9120W(R/L)J AND RS9120WRU models

FRAMELESS CABINETRY

(Frameless: Aligns the refrigerator with the cabinetry)

Note: shown with custom panel and handles attached to fridge

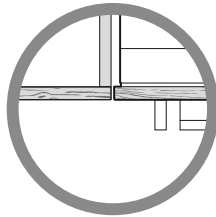

(refer to the flip side of the booklet)

FRAMED CABINETRY

(Framed: Aligns the refrigerator with the frame of the cabinetry)

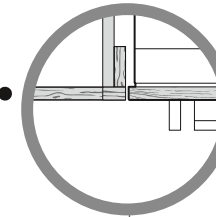

Note: shown with custom panel and handles attached to fridge

FRAMED CABINETRY

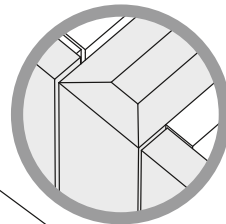

This booklet describes the installation process for framed cabinetry (for frameless cabinetry please refer to flip side of booklet).

- ① SAFETY AND WARNINGS
- ② BEFORE INSTALLATION
- ③ COMPONENTS LIST
- ④ PRODUCT AND CAVITY DIMENSIONS
- ⑤ CUSTOM DOOR PANEL DIMENSIONS
- ⑥ CAVITY PREPARATIONS
- ⑦ MAXIMUM DISTANCE OF HOSE AND POWER CORD

- ⑧ 2134mm HEIGHT CAVITY
ATTACH ANTI-TIP BRACKET
ATTACH TOP TRIM

OR

- ⑧ 2032mm HEIGHT CAVITY
ATTACH ANTI-TIP BRACKET

- ⑨ ATTACH SIDE BASE BRACKETS AND DOOR STUDS
- ⑩ CONNECT TO WATER AND ELECTRICAL SUPPLY
- ⑪ PRE-ALIGN YOUR PRODUCT INSIDE CABINETRY
- ⑫ INSTALL WATER FILTER CARTRIDGE AND KICKSTRIPS
- ⑬ ASSEMBLE DOOR PANEL SET
- ⑭ HANG WATER DISPENSING DOOR PANEL
- ⑮ HANG NON-WATER DISPENSING DOOR PANELS
- ⑯ ICE AND WATER INITIATION
- ⑰ ATTACH FIXING BRACKETS
- ⑱ ATTACH COVERS
- ⑲ ATTACH TOE KICK
- ⑳ ATTACH BOTTOM KICKSTRIP

- ㉑ ATTACH SIDE TRIM BRACKETS -
(A) FLEXIBLE SPRING CLIP METHOD
(Recommended method)

OR

- ㉑ ATTACH SIDE TRIM BRACKETS -
(B) FIXED SCREW METHOD

- ㉒ ADJUST HINGE TENSIONING SCREWS

- ㉓ FINAL CHECKLIST

① SAFETY AND WARNINGS

⚠ WARNING!



Electric Shock Hazard
Read and follow the safety and warnings outlined in this installation guide before operating this appliance.
Failure to do so can result in death, electric shock, fire or injury to persons.

⚠ WARNING!



Cut Hazard
Take care – panel edges are sharp. Failure to use caution could result in injury or cuts.

⚠ WARNING!



This appliance is top-heavy and must be secured to prevent the possibility of tipping forward.
To ensure that the appliance is stable under all loading conditions, the anti-tip bracket and fittings supplied must be installed according to the following installation instructions by a professional installer.

② BEFORE INSTALLATION

Please follow the installation steps specified to ensure your appliance is installed and operates correctly.

Refrigeration alcove preparation

- For integrated installation, a finished return of solid material is required across the top and sides of the new or existing alcove.
- It is recommended that the return be at least 88.9mm deep across the sides.

Refer to page 13 prior to installation of the refrigerator.

Power

- Connect your refrigerator to its own power point.
 - Avoid sharing the power point with other appliances to prevent accidental switching off of the refrigerator.
- For power requirements, please refer to the information on the serial plate. This is located at the front right-hand side of the drawer when open.
- Ensure your refrigerator is properly grounded (earthed).
- Connect the refrigerator to an electrical supply 220V – 240V, 50Hz with the fitted plug and lead.
- Follow the National Electrical Code and all local codes and ordinances when installing this refrigerator.

Location

- Do not place your refrigerator in direct sunlight or beside any heat generating appliance eg cooktop, oven or dishwasher.
- Your refrigerator has front and rear rollers for moving the refrigerator forward and backward.
- Do not move the refrigerator sideways to avoid damaging the rollers or the floor covering/surface.

Plumbing

- Your refrigerator must be installed by a qualified appliance installer as incorrect plumbing can lead to water leaks.
- Fisher & Paykel Appliances does not accept responsibility for damage (including water damage) caused by faulty installation or plumbing.

Door panel set

- The standard appliance does not include a door panel set.
- Custom door panels can only be used with Automatic ice dispensing models.
- For a custom integrated design on Automatic ice models, customers should supply their own custom door panel set to match their cabinetry. All the hardware required to mount the door panel sets to the refrigerator doors is supplied with the refrigerator.
- Door panel sets are available through your Fisher & Paykel dealer.
 - Fisher & Paykel door panel sets are available (EZKleen stainless steel door panels) model numbers: RD9121W(L/R), RD9121WRU
- Handle sets are optional for custom door panels and can also be purchased through your Fisher & Paykel dealer.

IMPORTANT! SAVE THESE INSTRUCTIONS

The models shown in this installation guide may not be available in all markets and are subject to change at any time. For current details about model and specification availability in your country, please go to our website www.fisherpaykel.com or contact your local Fisher & Paykel dealer.

3 COMPONENTS LIST

Door panel fittings – Included with standard refrigerator.

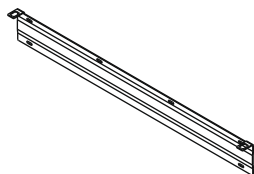

Door hanging bracket
(1)

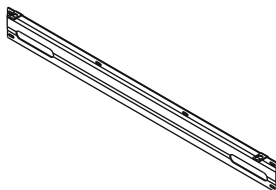

Drawer hanging bracket
(1)

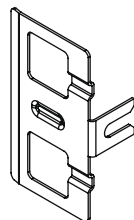

Side bracket
(6)



Side strap
(6)



M5 x 10 pan head
Phillips screw
(6)



#8 x 16 mush washer screw
(35)
(12) for Side trim attachment:
Fixed screw method only)

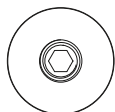

M8 stud
(5)

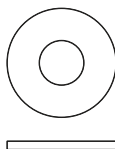

M8 washer
(4)



M8 nut
(4)

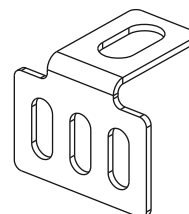

Locking bracket
(1)

Anti-tip bracket fittings – Included with standard refrigerator.

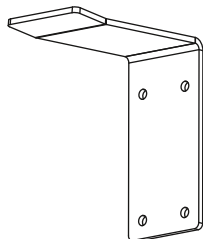

Anti-tip bracket
(1)

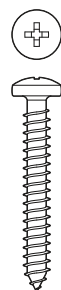

#10 x 40 pan head
Phillips screw
(4)

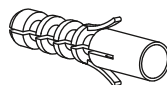

Masonry plug
(4)

3 COMPONENTS LIST

Optional accessories – The standard appliance does not include a door panel set.

Fisher & Paykel (EZKleen stainless steel) door panel sets are available. For models with a water dispenser, the stainless steel door panel sets are required.

For complete integration of Automatic ice models a custom door panel set is required. Door handle kits are available as an accessory for custom door panels.

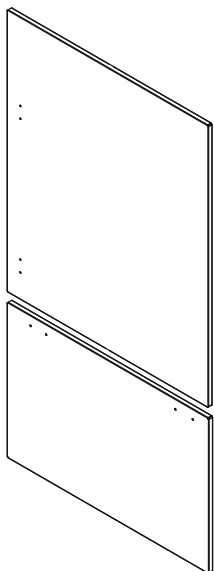

Door panel set:

Automatic ice dispensing door panel (1)
Drawer panel (1)

Part numbers:

F&P: RD9121W(L/R)

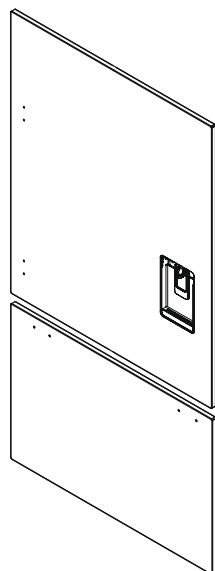

Door panel set:

Ice & Water door panel (1)
Drawer panel (1)

Part numbers:

F&P: RD9121WRU

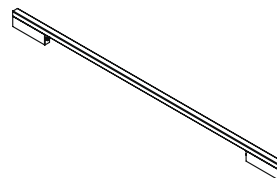

F&P: Door handle (2)



M5 x 25 pan head
socket screw
(8)



M5 x 14 Mush Phillips SS
(34)

Water fittings – Included with the standard appliance.



Collet locking key
(1)

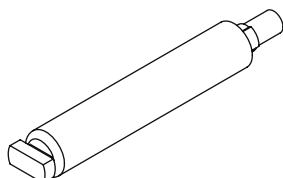

Water filter cartridge (1)
Part number: 847200

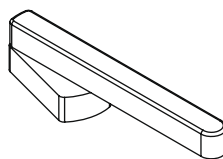

Filter cartridge tool
(1)

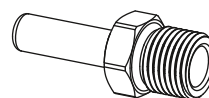

6mm Adaptor
(1)

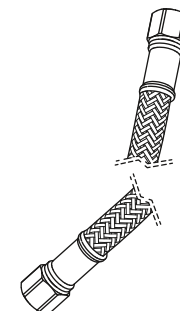

6mm comp.
Stainless Steel braided hose
(1)

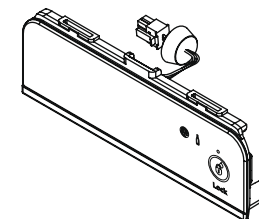

External display module (1)
(included with water
dispensing refrigerator)

3 COMPONENTS LIST

Product hardware - Included with standard refrigerator.

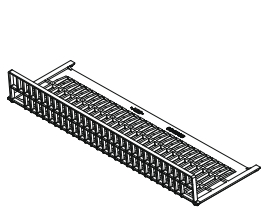

Kickstrip filter
(1)

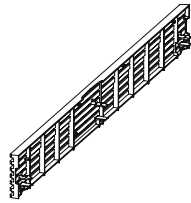

Top kickstrip grille
(1)

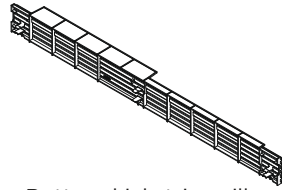

Bottom kickstrip grille
(1)



Stainless steel toe kick
(1)



Cabinet side trim
(2)

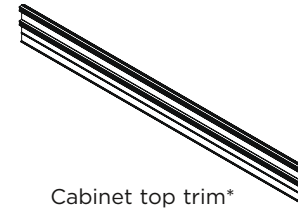

Cabinet top trim*
(1)



Cabinet top trim joining bracket*
(2)

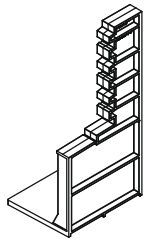

Air divider
(1)



Screw cover
(4)

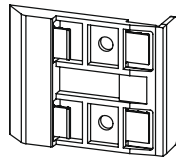

Cabinet side trim bracket
(6)

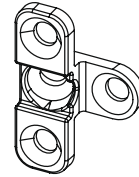

Fixing bracket
(4)

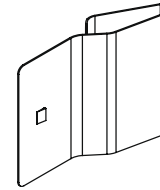

Spring Clip (6)
(for Cabinet side trim attachment: Flexible spring clip method only)

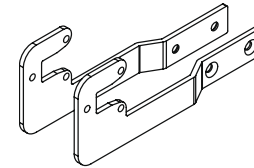

Side base bracket
(2)

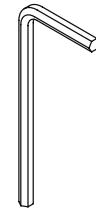

Allen key
(1)



M5 nut
(4)

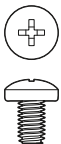

M5 x 8 pan head Phillips screw
(4)



M5 x 8 countersunk Phillips screw
(12)



#8 x 16mm pan head screw
(3)



#8 x 19 twin thread screw
(8)

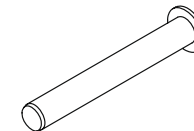

Hinge limiting pin
(1)



Drawer top trim
(1)

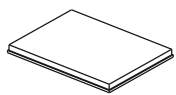

3M Dual Lock™ tabs
(10)

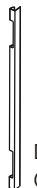

Drawer side trim
(2)



Door side trim
(2)

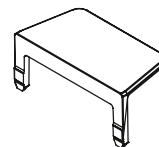

Side cover
(4)

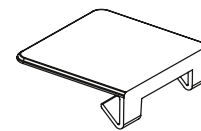

Top cover
(2)

* To be used when finished enclosure is 2134mm.

④



FRONT VIEW



PROFILE VIEW

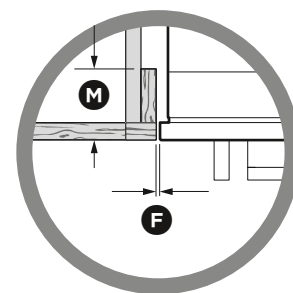

PLAN VIEW

CAVITY DIMENSIONS

PRODUCT DIMENSIONS

mm

④ Overall height of refrigerator*	2130
-----------------------------------	------

⑤ Overall width of refrigerator 906

(F) Minimum cabinetry gap clearance from edge of refrigerator 4

⑥	Overall depth of refrigerator (excl. front door panels)	606
---	---------------------------------------------------------	-----

④	Depth of stainless steel toe kick (measured from front of door panels)	71 - 101
---	------------------------------------------------------------------------	----------

① Height of stainless steel toe kick** 102

① Height of bottom drawer panel 772

Ⓚ Height of top door panel 1252

④ Depth of refrigerator front panels (excludes handles)*** 19

Ⓜ Cabinetry finished return (side and top of cavity) min. 127

Height of front panels with required gap above = 2134mm (Ⓓ product height + Ⓕ cabinetry gap).

✱

✱

* *

* *

4 PRODUCT AND CAVITY DIMENSIONS - WITH RD9121W DOOR PANEL SET

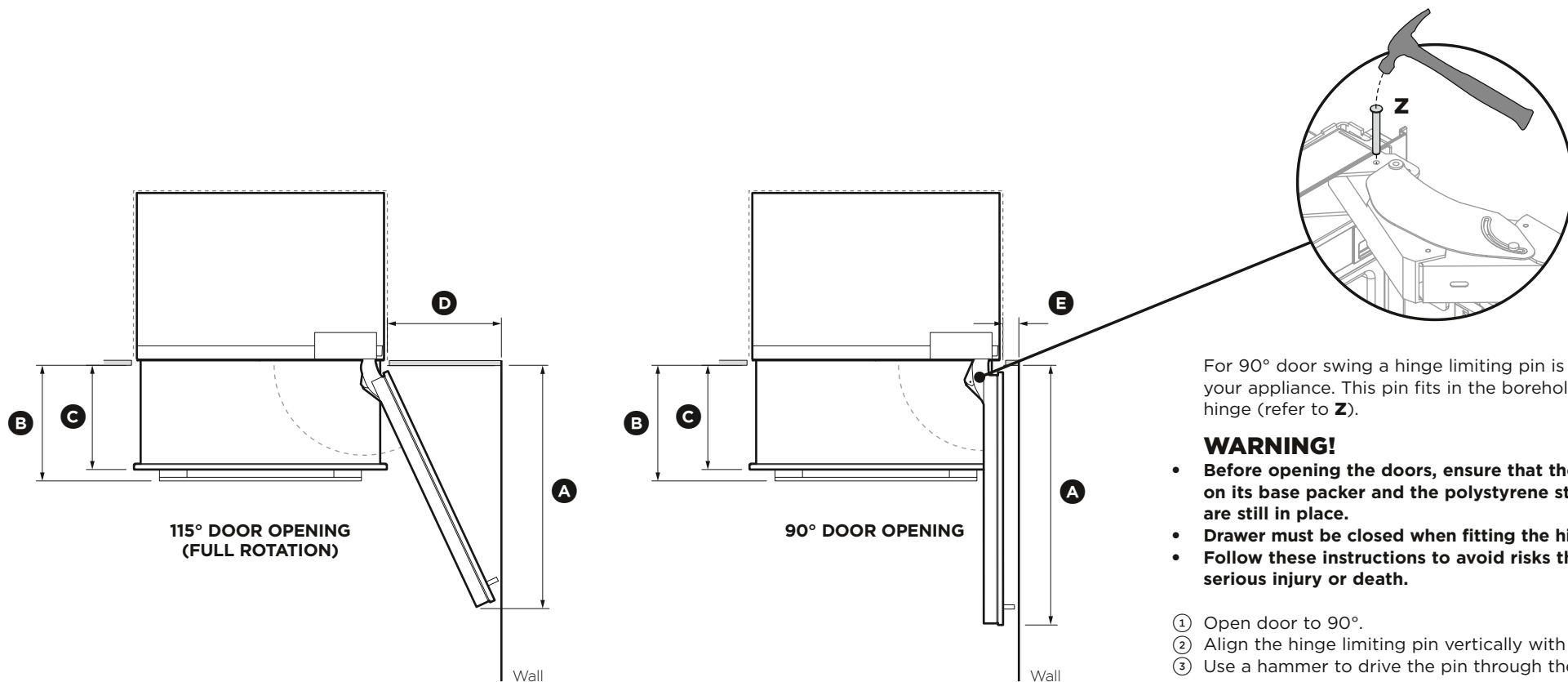

For 90° door swing a hinge limiting pin is supplied with your appliance. This pin fits in the boreholes of the top hinge (refer to **Z**).

WARNING!

- Before opening the doors, ensure that the refrigerator is on its base packer and the polystyrene stability blocks are still in place.
- Drawer must be closed when fitting the hinge limiting pin.
- Follow these instructions to avoid risks that can cause serious injury or death.

- ① Open door to 90°.
- ② Align the hinge limiting pin vertically with the bore hole.
- ③ Use a hammer to drive the pin through the bore hole.

DOOR OPENING AND CLEARANCE DIMENSIONS		RS9120WRU RS9120W(R/L)J
		mm
(A)	Depth of door (widest opening) measured from front of door	940
(B)	Depth of drawer (open) measured from front of drawer, including handle	400
(C)	Depth of drawer (open) measured from front of drawer, excluding handle	360
(D)	Minimum door clearance to adjacent wall* (115° - full internal access)	410
(E)	Minimum door clearance to adjacent wall* (90° - reduced internal access)	110

* Measured from front cabinetry edge.

4 PRODUCT AND CAVITY DIMENSIONS

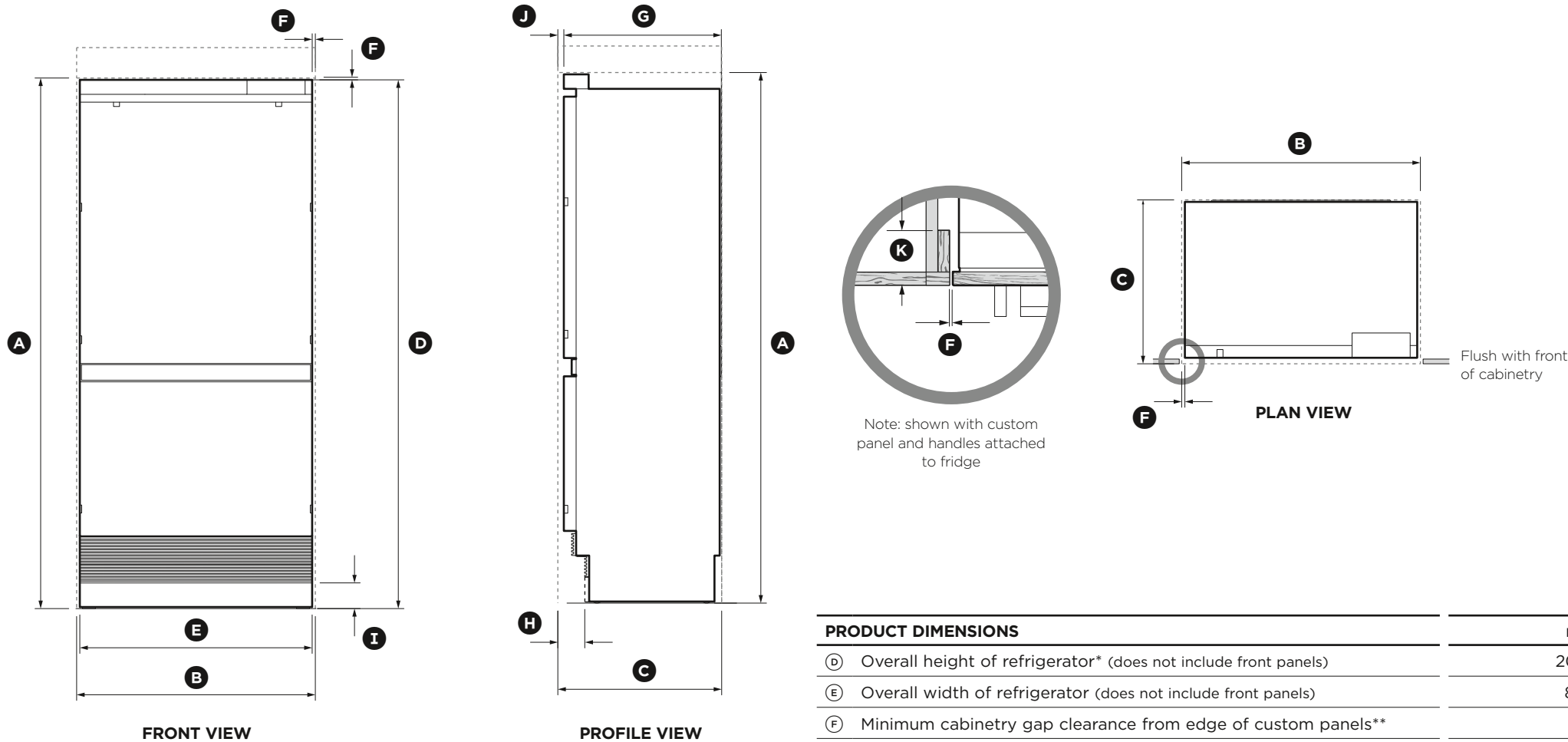

CAVITY DIMENSIONS	mm
Ⓐ Overall height of cavity*	2032/2134
Ⓑ Overall width of cavity	914
Ⓒ Overall depth of cavity**	635

Total front panel width with required gaps at sides = 914mm. Refer to 'Custom door panel dimensions' section – panel width + 2 x Ⓕ cabinetry gaps).

* Supplied top trim enables cavity height to be either 2032mm or 2134mm.

** Assumes a door panel thickness of 19mm.

PRODUCT DIMENSIONS	mm
Ⓓ Overall height of refrigerator* (does not include front panels)	2028
Ⓔ Overall width of refrigerator (does not include front panels)	890
Ⓕ Minimum cabinetry gap clearance from edge of custom panels**	4
Ⓖ Overall depth of refrigerator (excl. front door panels)	606
Ⓗ Depth of toe kick (measured from front of door panels***)	71 – 101
Ⓘ Height of custom toe kick****	102 – 152
Ⓙ Depth of refrigerator front panels (excludes handles)***	19
Ⓚ Cabinetry finished return (side and top of cavity)	min. 127

* Includes mounted feet.

** Refer to 'Custom door panel dimensions' section.

*** Door panels to be manufactured and fitted by cabinetmaker, maximum thickness 19mm.

**** Stainless steel toe kick provided with appliance. Alternatively, customers can supply their own toe kick, height 102 – 152mm.

RS9120WJ model shown only.

When designing custom door panels, these are only available for Automatic ice models.

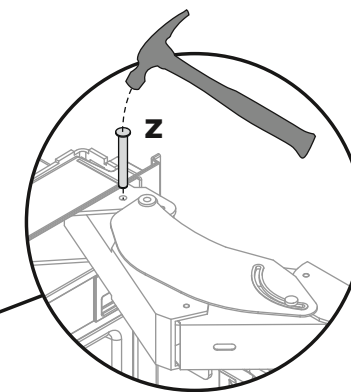
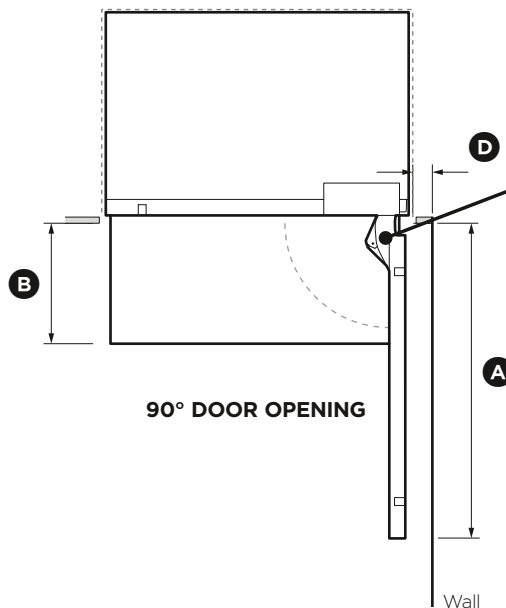
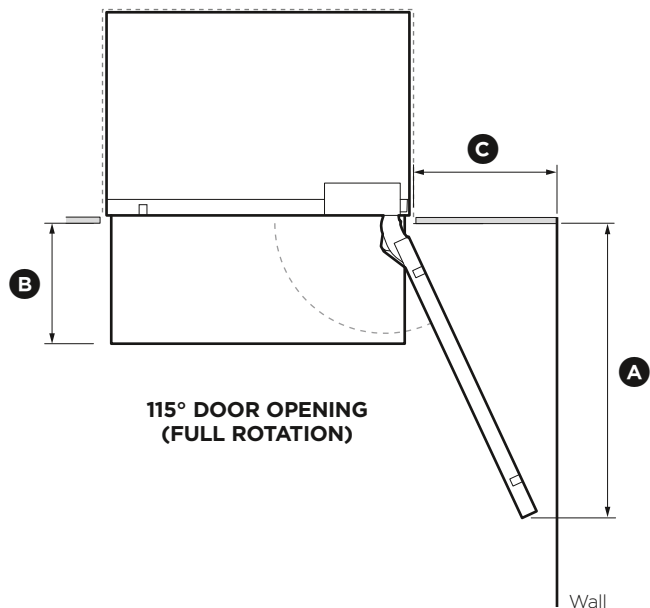

For 90° door swing a hinge limiting pin is supplied with your appliance. This pin fits in the boreholes of the top hinge (refer to **Z**).

WARNING!

- Before opening the doors, ensure that the refrigerator is on its base packer and the polystyrene stability blocks are still in place.
- Drawer must be closed when fitting the hinge limiting pin.
- Follow these instructions to avoid risks that can cause serious injury or death.

- ① Open door to 90°.
- ② Align the hinge limiting pin vertically with the bore hole.
- ③ Use a hammer to drive the pin through the bore hole.

DOOR OPENING AND CLEARANCE DIMENSIONS

① Depth of door (widest opening) measured from front of door

② Depth of drawer (open) measured from front of cabinetry*

③ Minimum door clearance** to adjacent wall* (115° - full internal access)

④ Minimum door clearance** to adjacent wall* (90° - reduced internal access)

mm

940

338

410

110

* Does not include the custom door panels or handles to be manufactured and fitted by cabinetmaker.

** Measured from front cabinetry edge.

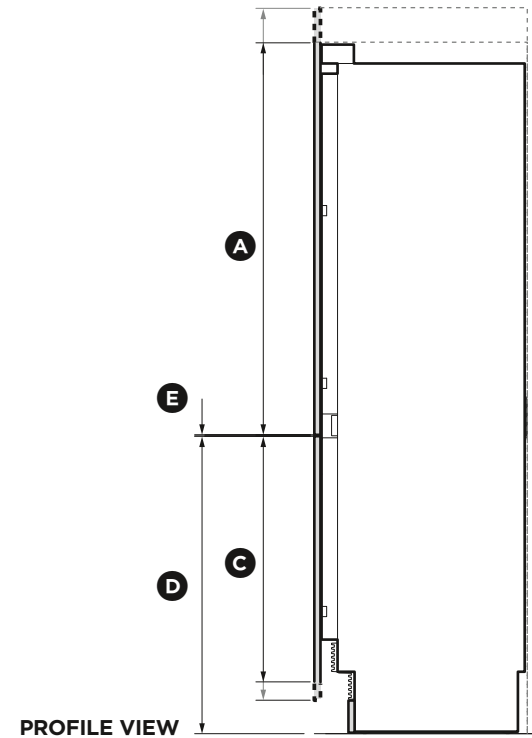
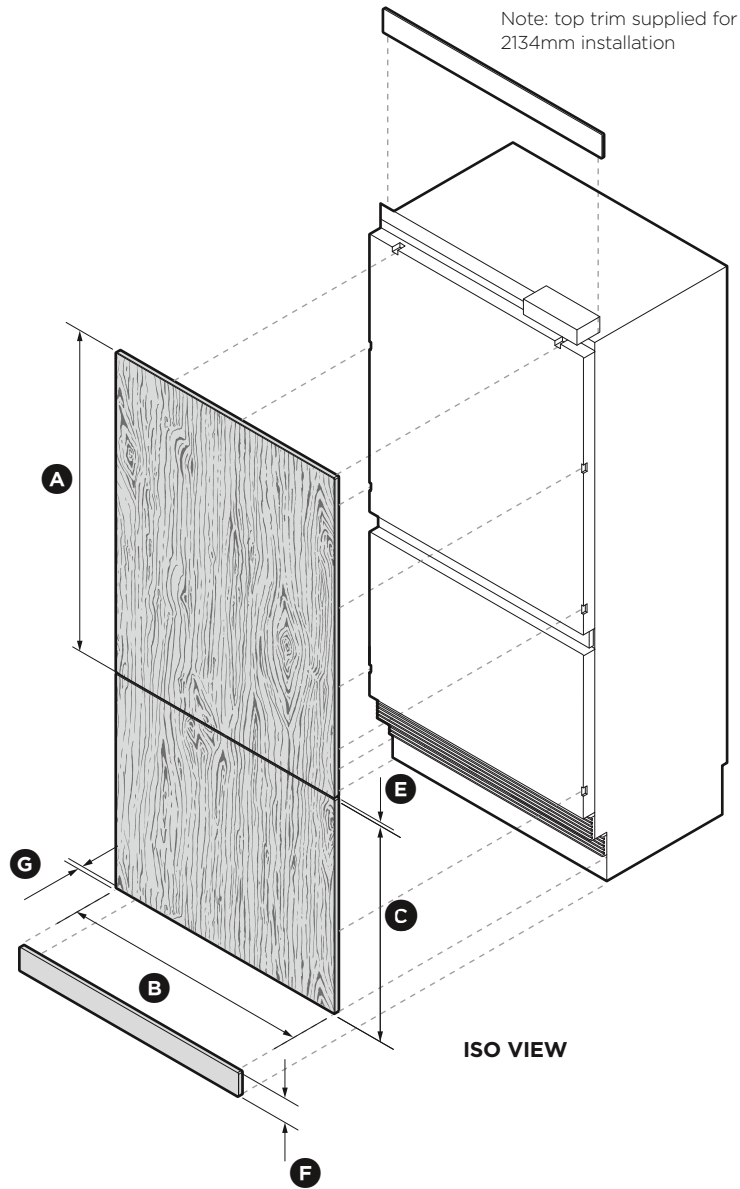

CUSTOM PANEL DIMENSIONS

mm

Ⓐ Height of top door panel*	1150/1252
Ⓑ Width of top door and bottom drawer panel	906
Ⓒ Height of bottom drawer panel**	722 - 772
Ⓓ Height from bottom of refrigerator to top of bottom drawer panel	874
Ⓔ Gap between top door panel and bottom drawer panel	4
Ⓕ Height of toe kick panel**	102 - 152
Ⓖ Depth of custom panels	min. 16, max. 25
Maximum weight of top door panel***	20kg
Maximum weight of bottom drawer panel***	11kg

Custom door panels to be manufactured and fitted by cabinetmaker.

Door handle kit is available as an optional accessory.

* Removable top trim allows installation into 2032mm or 2134mm H cavity. Ensure top door panel height corresponds to cavity height.

** Stainless steel toe kick, height 102mm is supplied with the appliance. For integrated installation, a custom toe kick 102 - 152mm can be manufactured and fitted by cabinetmaker. The bottom grille can be reduced to allow for a higher toe kick. Adjust the height of the bottom drawer panel accordingly.

*** Includes weight of handle.

RS9120WJ models shown only.

When designing custom door panels, these are only available for Automatic ice models.

The drawings below apply to Automatic ice models, (RS9120W(R/L)J). Dimensions apply for the preparation and installation of custom door panels.
For Dwg and Dxf files of the below panel preparation download the folder on <http://thekitchentools.fisherpaykel.com>

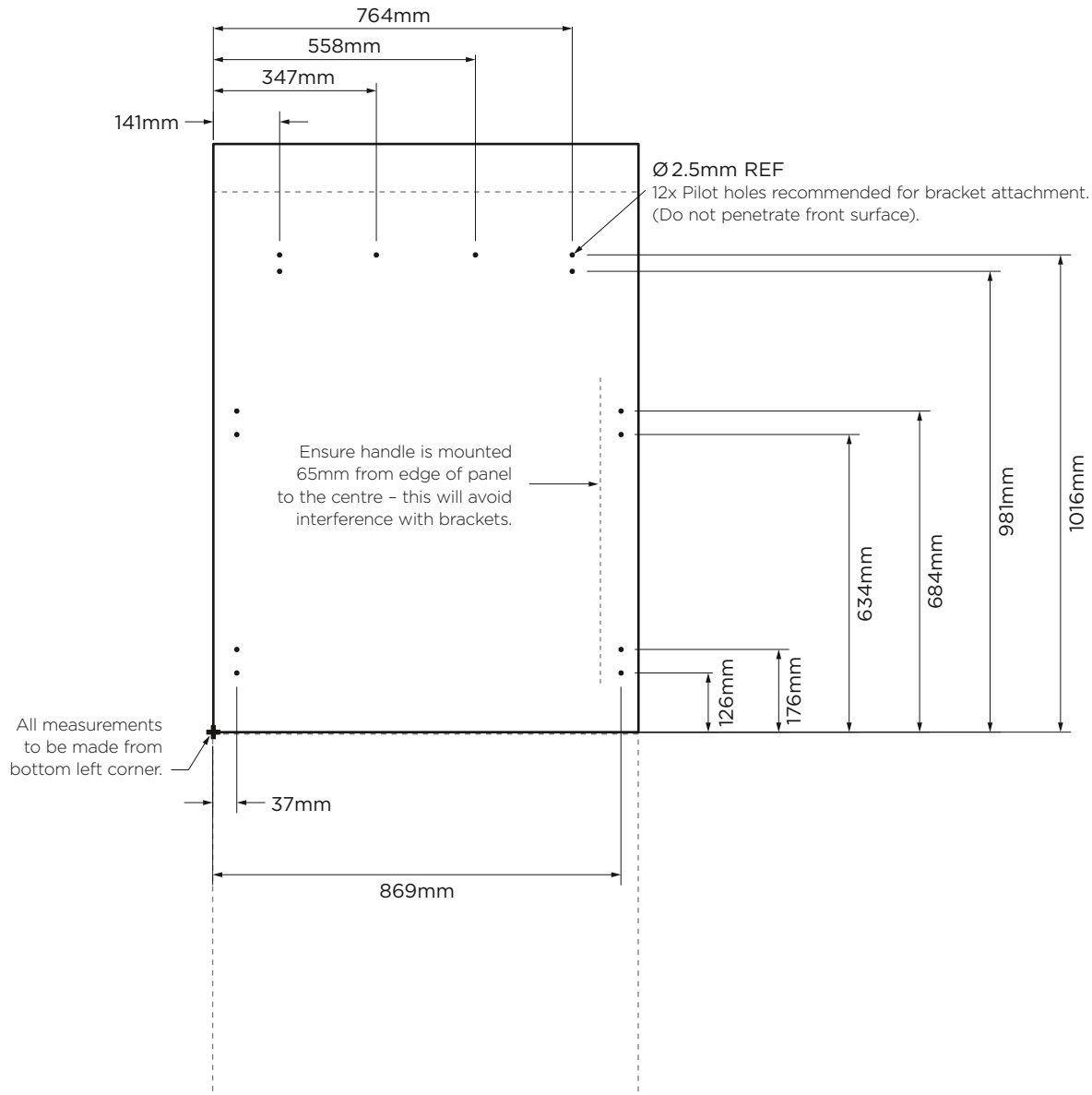

TOP PANEL - REAR VIEW

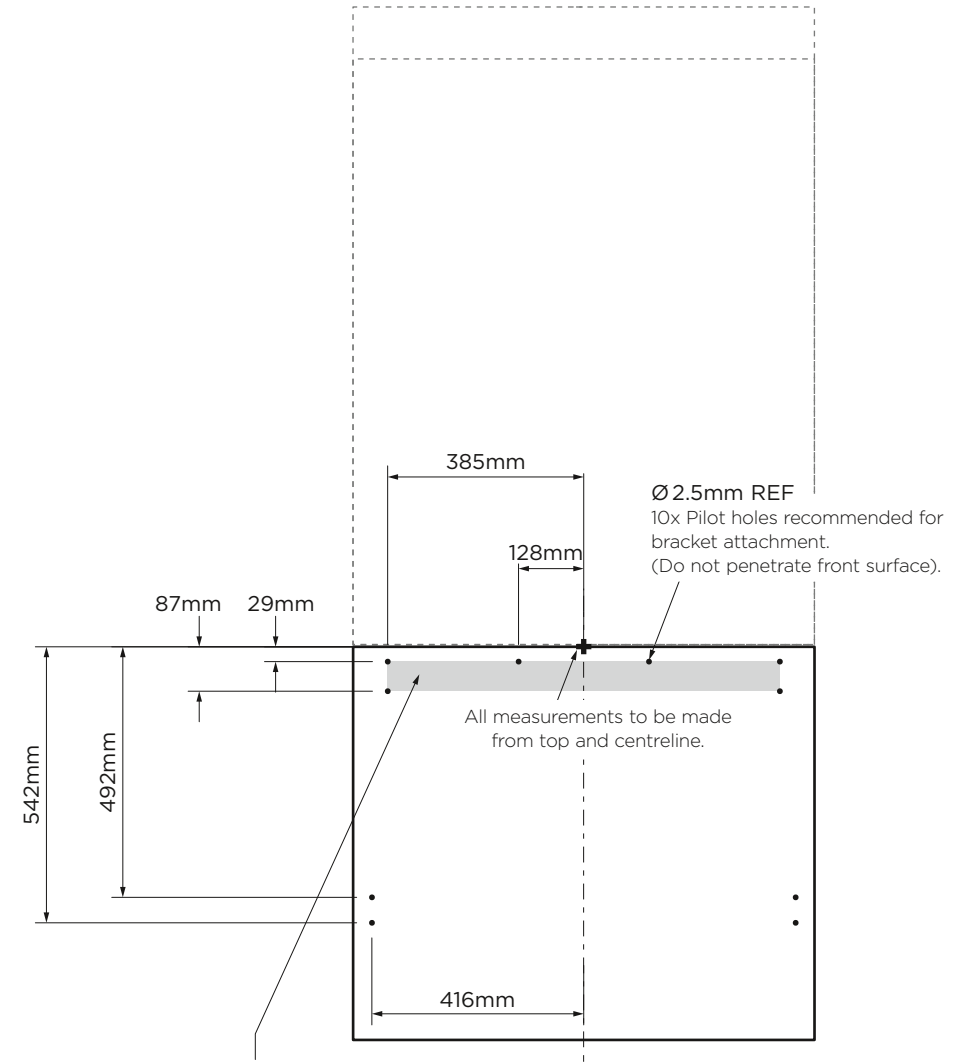

Cutouts are located in attachment bracket for Fisher & Paykel handles only. If locating custom handle in the shaded area shown above, ensure handle screw heads are countersunk into back of panel to avoid interference with hanging bracket.

BOTTOM PANEL - REAR VIEW

6 CAVITY PREPARATIONS

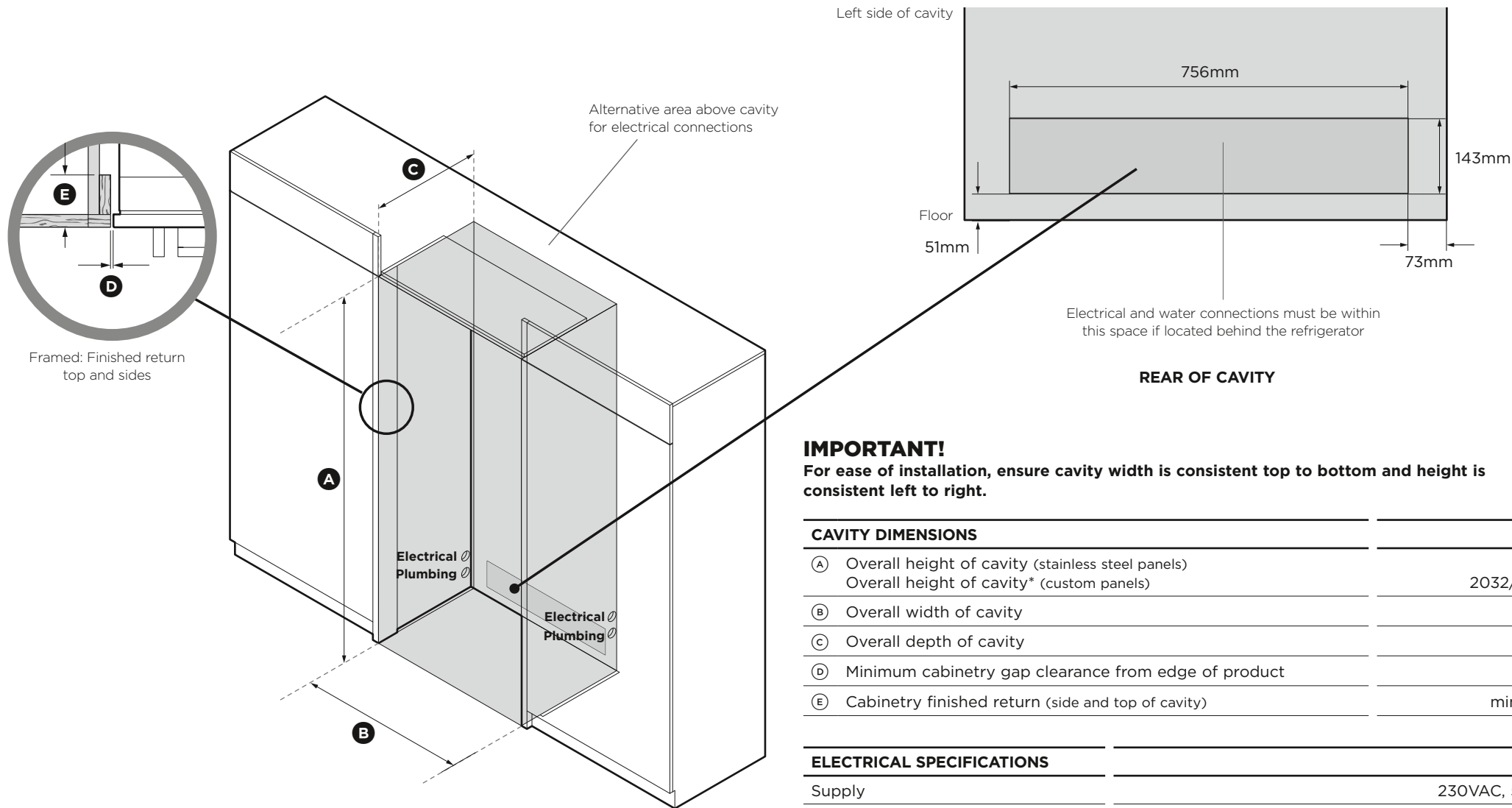

For integrated installation, ensure dimensions of finished return dimensions are as shown.

- Note: electrical connection can be located in an adjacent cabinet to either side of the fridge or above the fridge cavity.
- * Ensure custom panel height corresponds to cavity height. Supplied top trim enables cavity height to be either 2032mm or 2134mm

⑦ MAXIMUM DISTANCE OF HOSE AND POWER CORD

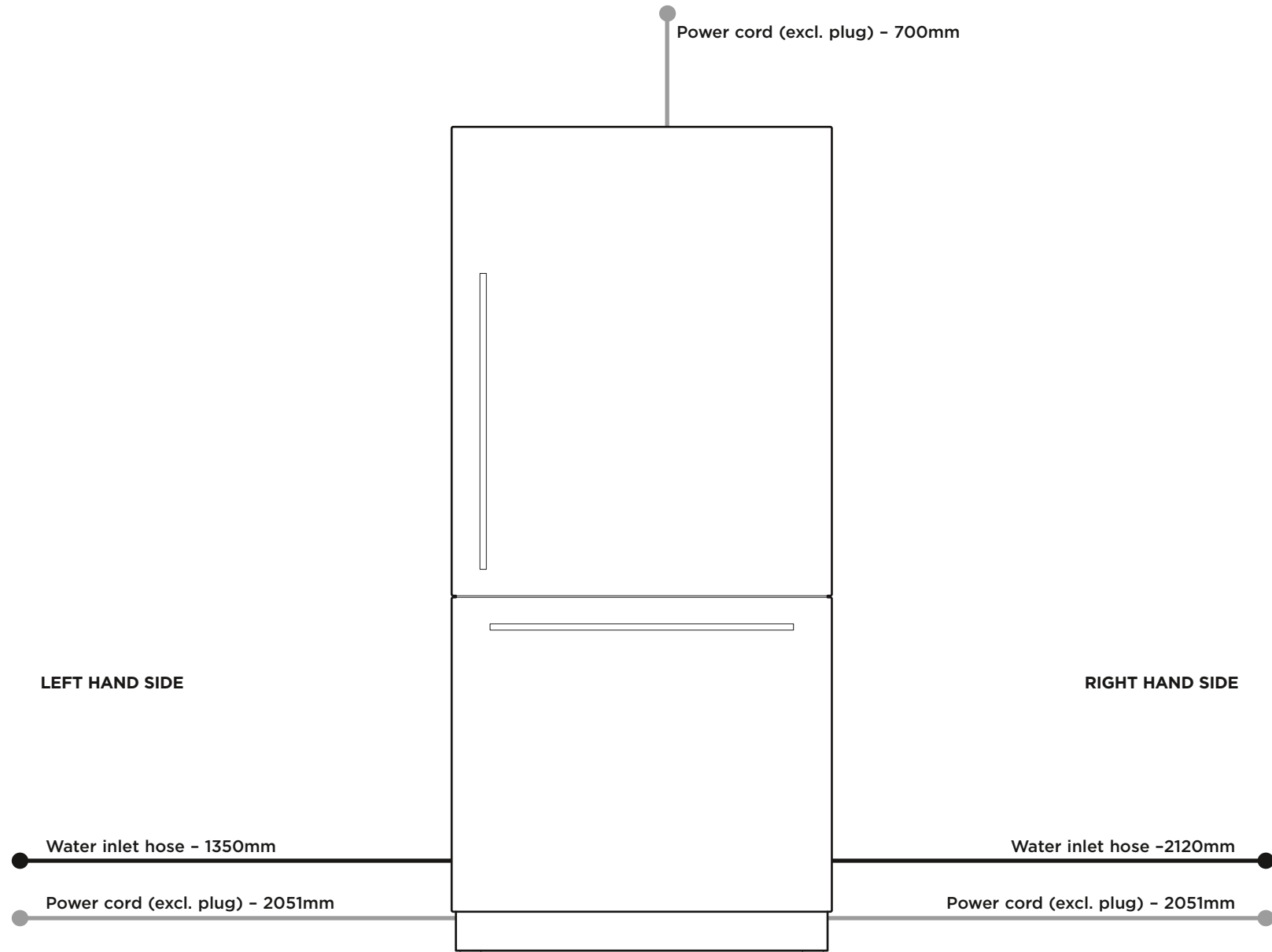

8 2134mm HEIGHT CAVITY - ATTACH ANTI-TIP BRACKET

Note: the recommended height of cavity is 2134mm for use with stainless door panels.

IMPORTANT!

Safety requires refrigerators to be stable when door and/or drawer, are open. The anti-tip bracket and fittings supplied must be fitted to the wall of the finished enclosure to withstand a 100kg load. This will prevent the possibility of the refrigerator tipping forward, when door and/or drawer, are open.

WARNING!

Failure to follow instructions can lead to serious injury or death.

When fastening with masonry plugs and/or screws:

- Ensure the screws avoid electrical, gas and water conduits.
- Ensure the surface the bracket is fastened to withstands a 100kg load.
- Ensure light-weight masonry material such as cinder block and new concrete (no curing time) are not used in installation.
- Do not use metallic materials that may corrode, stain and/or damage the enclosure

For 2134mm cavity installation

Wooden/plaster board wall installation

- ① Project the end of the above finished enclosure to the centre of the back wall and subtract 164mm. This will locate the contact surface between the bracket and the appliance (refer to **A**).

Ensure a structural beam/wall stud closest to the centre of the wall enclosure is located.

- ② Fix bracket to the wall with screws x4 (#10 x 40 pan head Phillips screws). Ensure screws hold tight and the bracket overlaps the appliance when it is positioned (min. 60mm) for a secure hold.

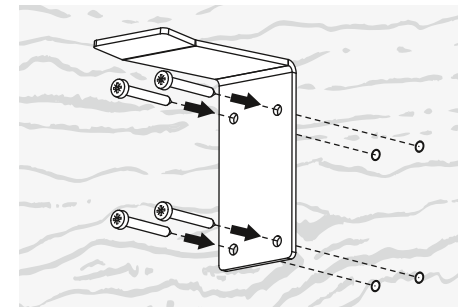
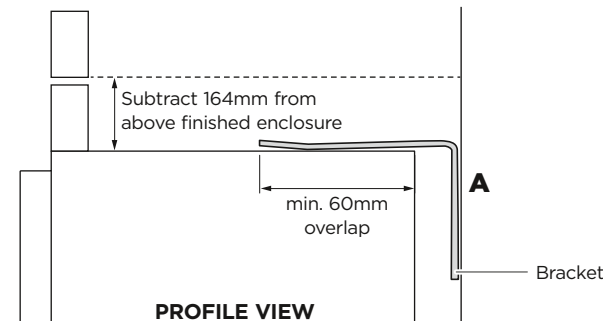

Solid wall installation

- ① Project the end of the above finished enclosure to the centre of the back wall and subtract 164mm. This will locate the contact surface between the bracket and the appliance (refer to **B**).
- ② Mark screw locations to drill Ø 6mm x 35mm deep holes. Hammer masonry plugs into the wall until flush x4. Fix bracket to the wall with screws x4 (#10 x 40 pan head Phillips screws). Ensure screws hold tight.

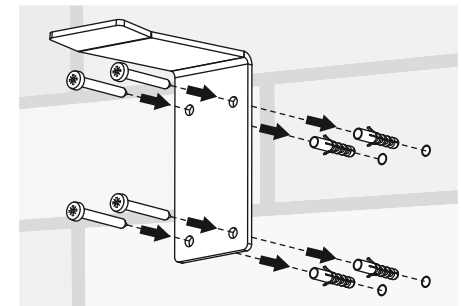
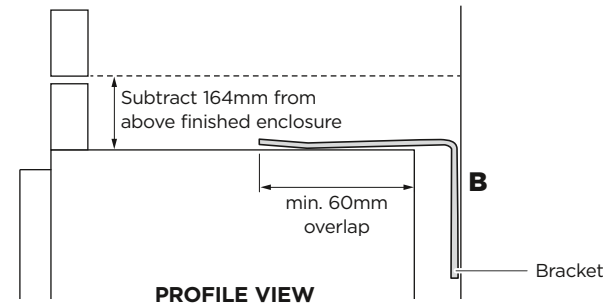

Spacer installation

If a minimum 60mm overlap cannot be achieved we recommend fastening a solid spacer (wooden beam etc) behind the bracket.

- ① Ensure the length of the spacer corresponds to the enclosure's width. Always secure the spacer to existing studs on the enclosure wall (refer to **C**).
- ② Fix bracket to the spacer with screws x4 (#10 x 40 pan head Phillips screws). Ensure screws hold tight and the bracket overlaps the appliance when it is positioned (min. 60mm) for a secure hold.

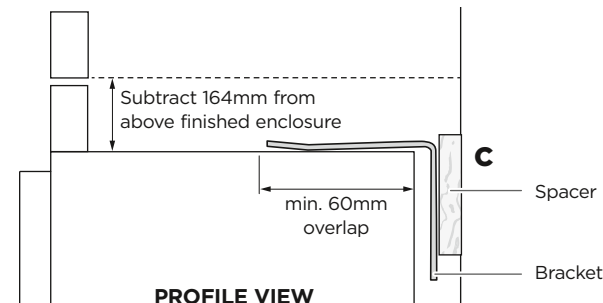

⑧ 2134mm HEIGHT CAVITY - ATTACH TOP TRIM

WARNING!

Take care when working with the refrigerator outside of the finished enclosure, as the refrigerator is not secured and has the possibility of tipping forward. Tipping of refrigerator can lead to serious injury or death.

- ① Ensure all external packaging material is removed from the refrigerator before installation.

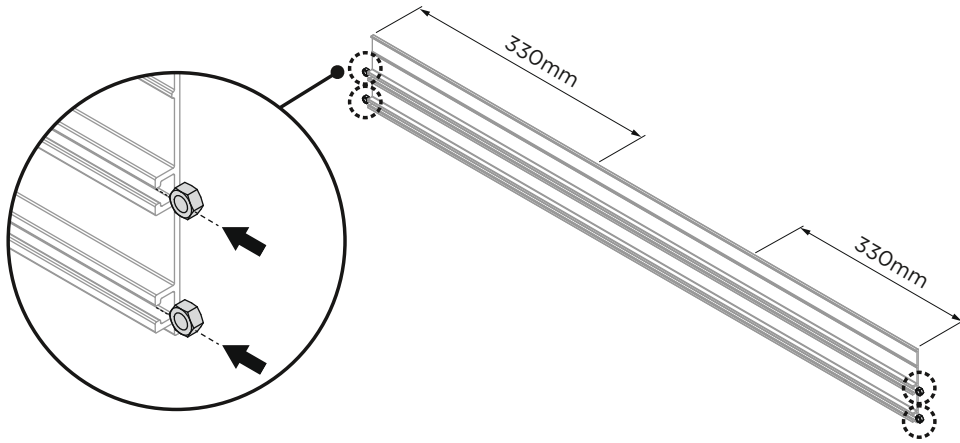

- ② On the right side of the top trim, insert M5 nuts x2 onto the top and bottom slide. Slide nuts towards the centre of the trim, 330mm.

Repeat this process on the opposite side.

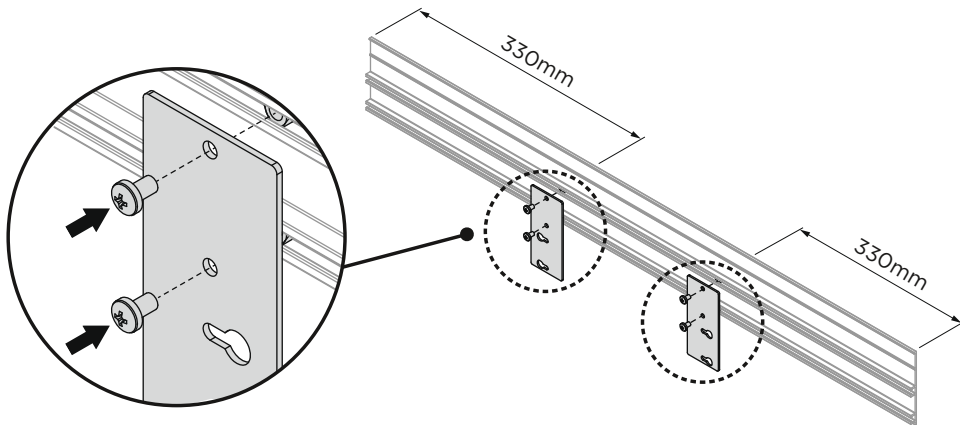

- ③ Position joining brackets over the M5 nuts. Thread screws x2 (M5 x 8 pan head Phillips screws) through bracket hole and secure.

Repeat this process on the opposite side.

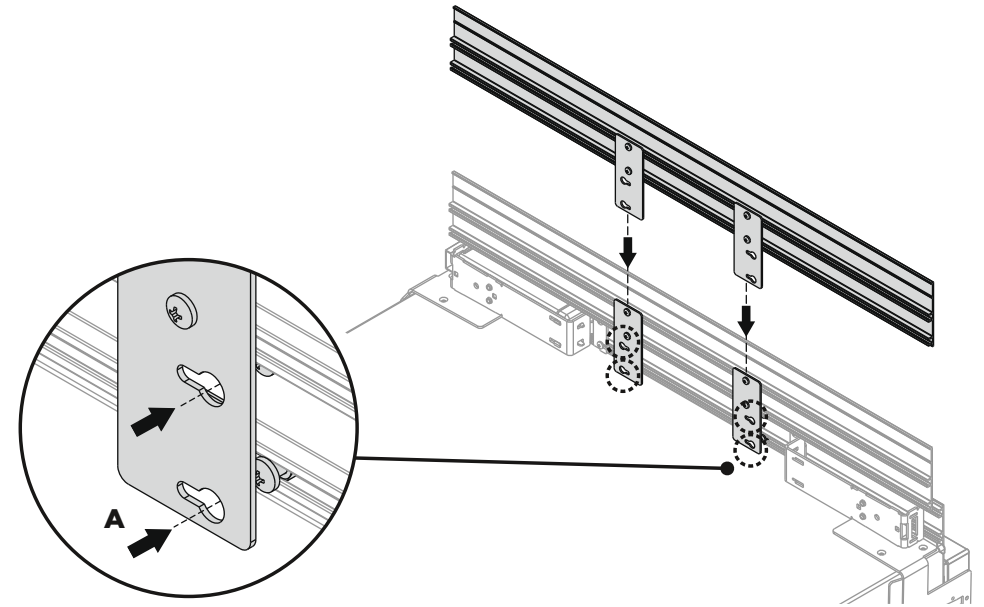

- ④ At the top of the refrigerator, place the assembled top trim behind the existing refrigerator trim. Bring the top trim forward and insert screw heads through the key holes of the joining brackets (refer to A).

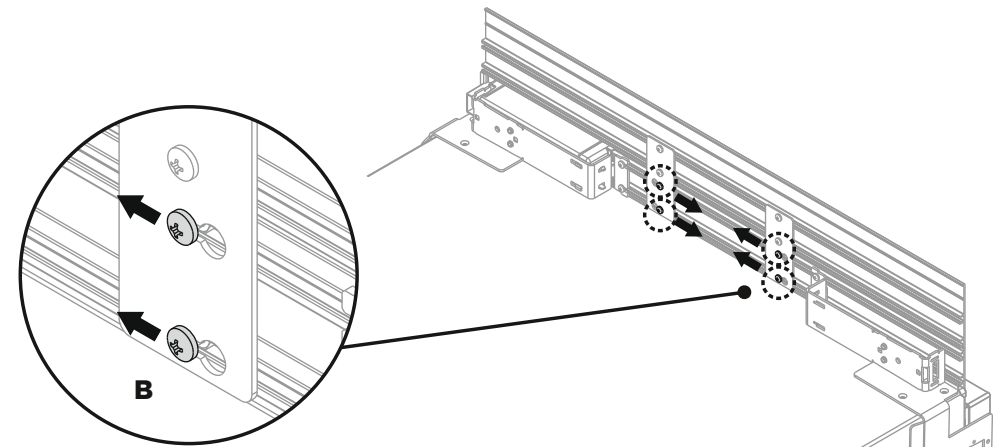

- ⑤ Slide the screws located on the refrigerator sideways towards the narrow side of the key holes on the joining bracket, and tighten screws to lock top trim in position (refer to B).

8 2032mm HEIGHT CAVITY - ATTACH ANTI-TIP BRACKET

Note: the overall cavity height of 2032mm is an optional installation for custom panels only.

IMPORTANT!

Safety requires refrigerators to be stable when door and/or drawer, are open. The anti-tip bracket and fittings supplied must be fitted to the wall of the finished enclosure to withstand a 100kg load. This will prevent the possibility of the refrigerator tipping forward, when door and/or drawer, are open.

WARNING!

Failure to follow instructions can lead to serious injury or death.

When fastening with masonry plugs and/or screws:

- Ensure the screws avoid electrical, gas and water conduits.
- Ensure the surface the bracket is fastened to withstands a 100kg load.
- Ensure light-weight masonry material such as cinder block and new concrete (no curing time) are not used in installation.
- Do not use metallic materials that may corrode, stain and/or damage the enclosure.

For 2032mm cavity installation

Wooden/plaster board wall installation

- ① Project the end of the above finished enclosure to the centre of the back wall and subtract 62mm. This will locate the contact surface between the bracket and the appliance (refer to **A**).

Ensure a structural beam/wall stud closest to the centre of the wall enclosure is located.

- ② Fix bracket to the wall with screws x4 (#10 x 40 pan head Phillips screws). Ensure screws hold tight and the bracket overlaps the appliance when it is positioned (min. 60mm) for a secure hold.

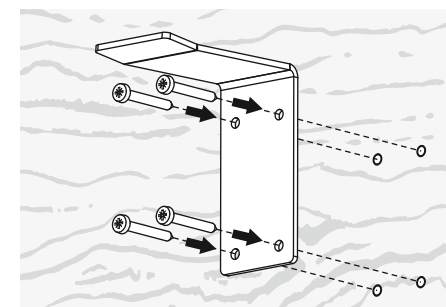
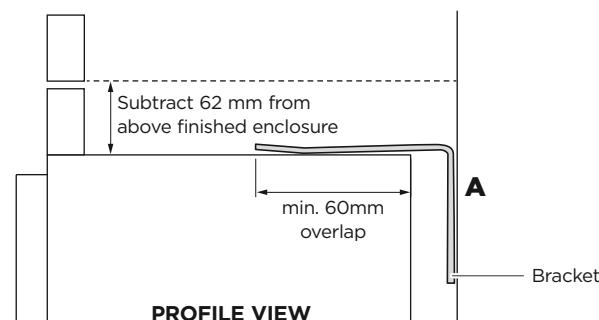

Solid wall installation

- ① Project the end of the above finished enclosure to the centre of the back wall and subtract 62mm. This will locate the contact surface between the bracket and the appliance (refer to **B**).

- ② Mark screw locations to drill Ø 6mm x 35mm deep holes. Hammer masonry plugs into the wall until flush x4. Fix bracket to the wall with screws x4 (#10 x 40 pan head Phillips screws). Ensure screws hold tight.

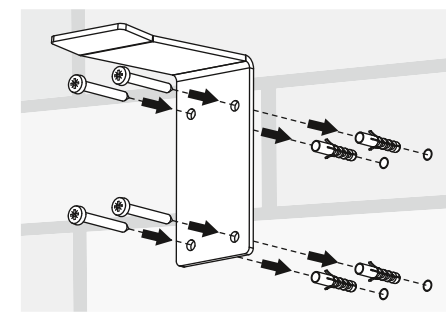
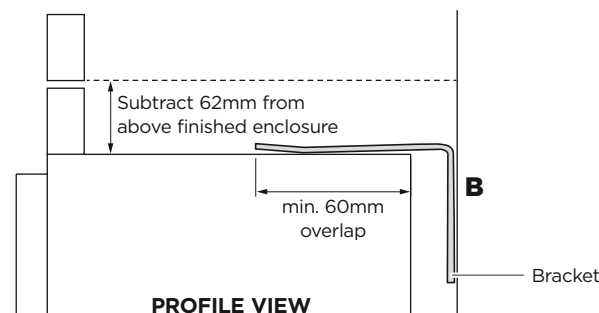

Spacer installation

If a minimum 60mm overlap cannot be achieved we recommend fastening a solid spacer (wooden beam etc) behind the bracket.

- ① Ensure the length of the spacer corresponds to the enclosure's width. Always secure the spacer to existing studs on the enclosure wall (refer to **C**).
- ② Fix bracket to the spacer with screws x4 (#10 x 40 pan head Phillips screws). Ensure screws hold tight and the bracket overlaps the appliance when it is positioned (min. 60mm) for a secure hold.

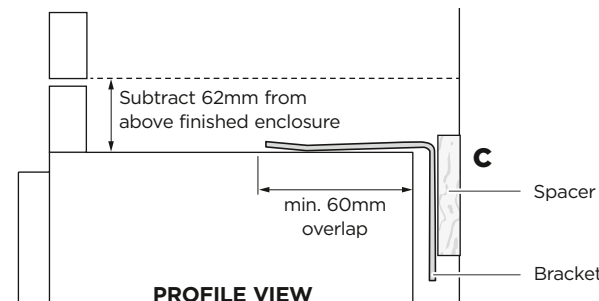

9 ATTACH SIDE BASE BRACKETS AND DOOR STUDS

WARNING!

Take care when working with the refrigerator outside of the finished enclosure, as the refrigerator is not secured and has the possibility of tipping forward. Tipping of refrigerator can lead to serious injury or death.

- ① Ensure all external packaging material is removed from the refrigerator before installation.
- ② At the base LH side of the refrigerator attach the LH side bracket to the dedicated threaded holes and secure with screws x2 (M5 x 8 countersunk Phillips screws).

Repeat this process on the RH side of the refrigerator.

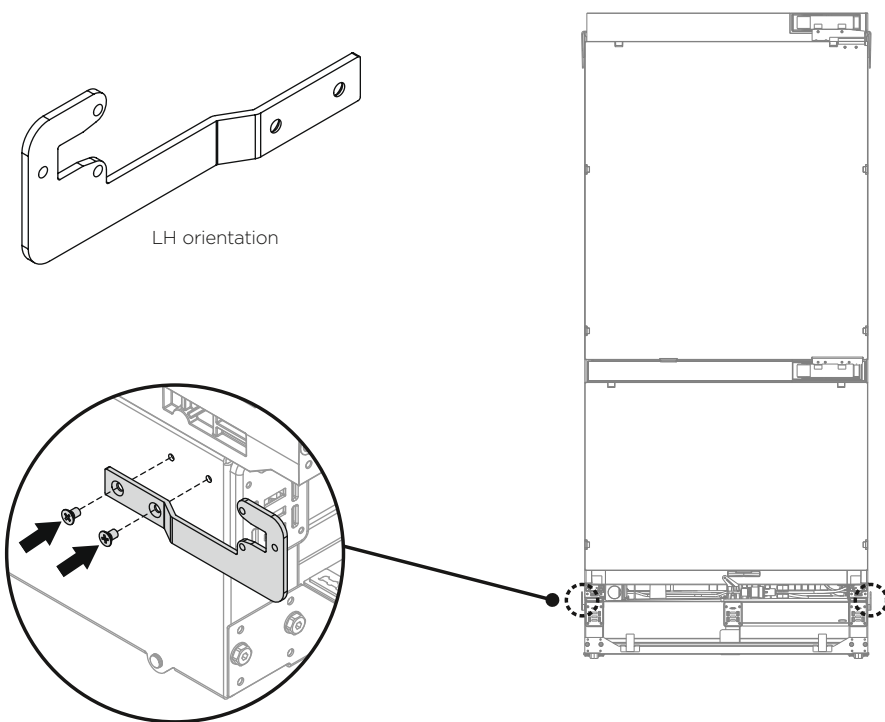

- ③ Secure M8 studs into the refrigerator doors, ensure the open end faces the top and the studs go all the way in.

Repeat this process for all refrigerator doors.

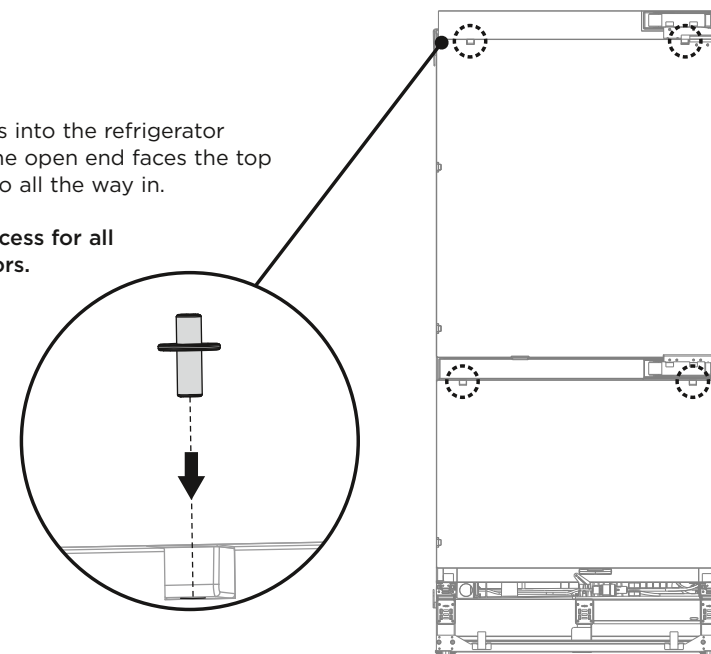

- ④ Loosely screw (1 - 2 turns) M5 x 10 pan head Phillips screws into doors.

Repeat this process for all refrigerator doors.

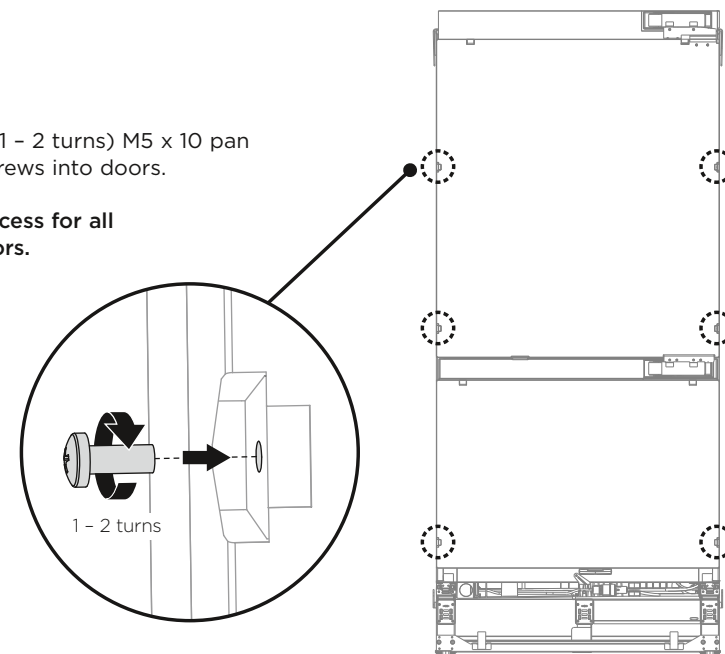

IMPORTANT!

- The water connection instructions below are intended only for the professional installer.
- **DO NOT** use with water that is microbiologically unsafe or of unknown quality.
- **WARNING** - connect to potable drinkable water supply only.
- **DO NOT** install on line pressure above 120psi (827kPa) or below 22psi (150kPa).
- **DO NOT** use on hot water supply (100°F [38°C max.]).
- **AVOID** contamination of pipes during installation.
- Old water fittings (hose-sets) should not be reused.
- The refrigerator includes a stainless braided water line hose.
- The shut off valve should be accessible.

- ① Ensure the refrigerator is NOT plugged into a power supply. Locate isolating tap for water connection – cold water supply only. Tee and tap fittings are not supplied.

Position the refrigerator 450 – 600mm in front of the finished enclosure. This will allow access behind the refrigerator for power and water connections.

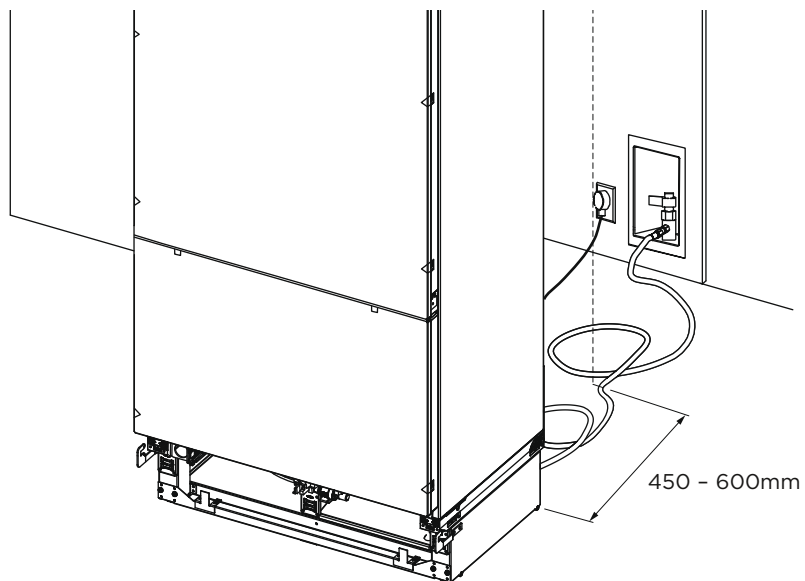

- ② At the front of the refrigerator, fasten the adaptor onto one end of the braided water line hose.

Note: the adaptor is not required for installation, if 6.35mm PEX plastic tubing (optional) is used.

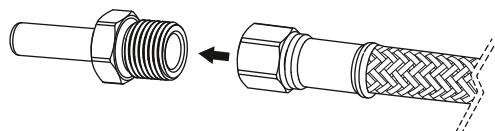

- ③ Firmly insert the tube end of the adaptor into the PLV, until the end is no longer visible. Once inserted, pull gently on tubing to ensure it is locked in (refer to **A**).

Note: dislodge the PLV if required.

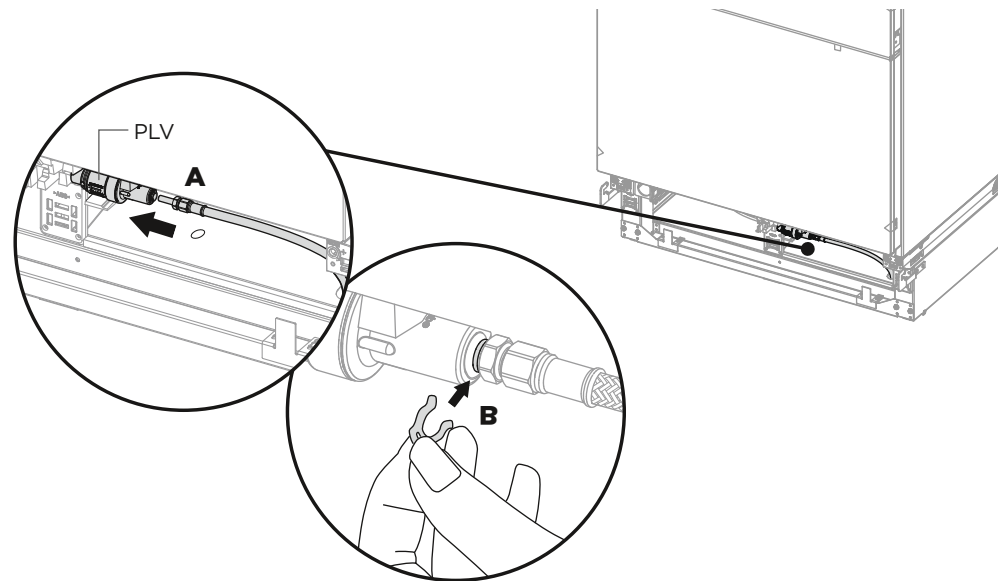

- ④ Secure connection by attaching the locking key in between the PLV and tube end of the adaptor (refer to **B**).

Note: if PLV was dislodged for installation (③), mount PLV back into clip.

- ⑤ Thread the free end of the water line hose into the dedicated hole located in the base of the refrigerator, through to the back of the refrigerator (refer to **C**).

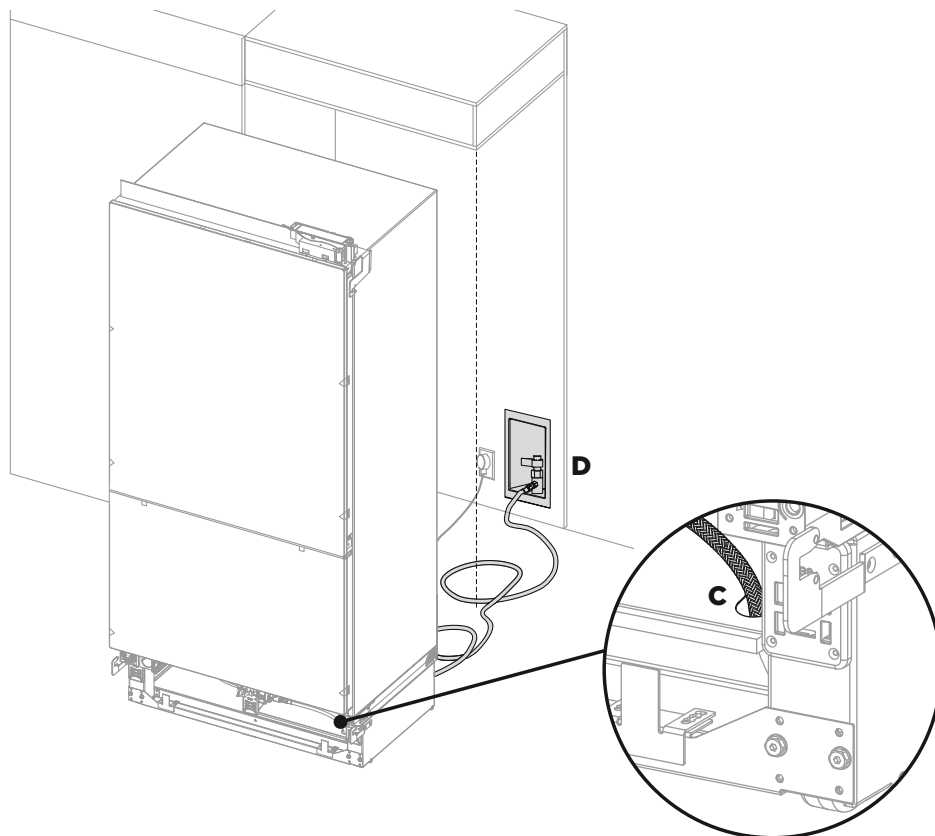

- ⑥ At the back of the refrigerator, loosely coil the water line hose (~2 - 3 times) and fasten the end of the hose to the cold water supply (refer to **D**).

Take care not to over-tighten the connection. Turn the isolating tap on and check that all connections are dry and free of drips.

- ⑦ At the back of your refrigerator, connect the refrigerator to the electrical supply (230VAC, 50Hz) with the fitted plug and lead, and turn on. Ensure the refrigerator is connected to its own isolating switch (refer to **E**).

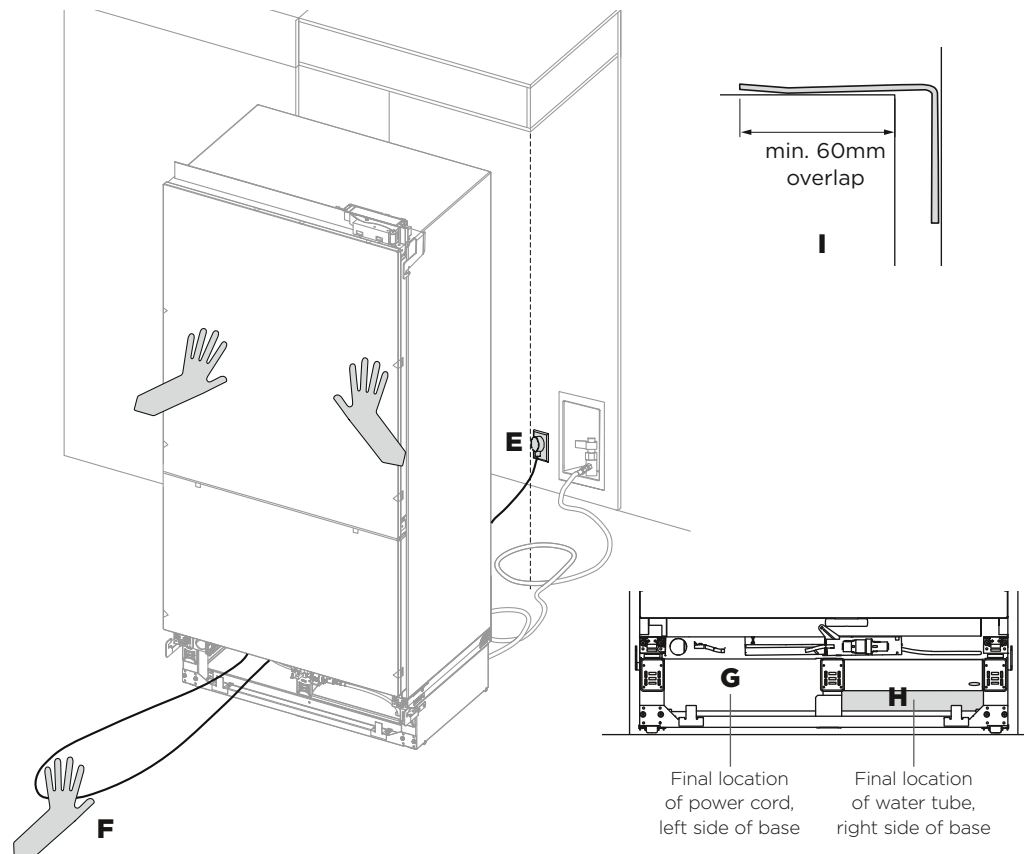

- ⑧ In order to push refrigerator into correct position:

- Stop midway, reach through base to locate power cord. Pull power cord through the front left side of the refrigerator (refer to **F**), tucking it neatly in the left side of the base (refer to **G**).
- Reach through base to locate water line hose coil. Tuck coil neatly into front right side of base (refer to **H**).

IMPORTANT!

Failure to do this can result in running over the hose causing damage and possible water leaks.

- Push the refrigerator until the doors are in line with the frame. Ensure the refrigerator is centred.
- Firm contact must be achieved between the refrigerator and the anti-tip bracket, min. 60mm overlap (refer to **I**).

WARNING!

Failure to follow this instruction can lead to serious injury or death.

IMPORTANT!

- It is important that the doors are in line with the cabinetry front and the refrigerator is centred before following these steps.
- It is important that all four corners of the refrigerator are supported firmly onto the floor to eliminate any movement.
- Installing the refrigerator on a soft, uneven, or not level floor may result in twisting of the refrigerator and poor door sealing.
- Raise the refrigerator using an 11mm hex socket or 4mm hex Allen key. One turn of height adjusting nuts is equivalent to 1mm height travel.
Note: maximum travel is 20mm.
- Use low torque setting to avoid damage to height adjustment system.

- ① Use the front and rear adjustment nuts (**A**) to align the front of the doors top to bottom on both sides. Depending on your installation design the refrigerator door may be flush with the cabinet frame or the cabinet door. Place a ruler on the front of the refrigerator to check flushness top and bottom, left and right. This step will help ensure the refrigerator is level with the adjacent cabinetry.

IMPORTANT!

Failure to achieve flushness top to bottom and/or uneven gaps left to right greater than 1.5mm can lead to difficulties achieving final alignment. Final alignment will be achieved once door panels have been installed and the refrigerator is pushed back to sit flush with cabinetry. Do not screw brackets to cabinetry at this stage.

- Turn adjustment nuts clockwise to raise or counter-clockwise to lower (refer to **A**).
- Check if the gaps between refrigerator and adjacent cabinetry are even on both sides (refer to **B**).
- Gently push the front of the refrigerator to check the stability.

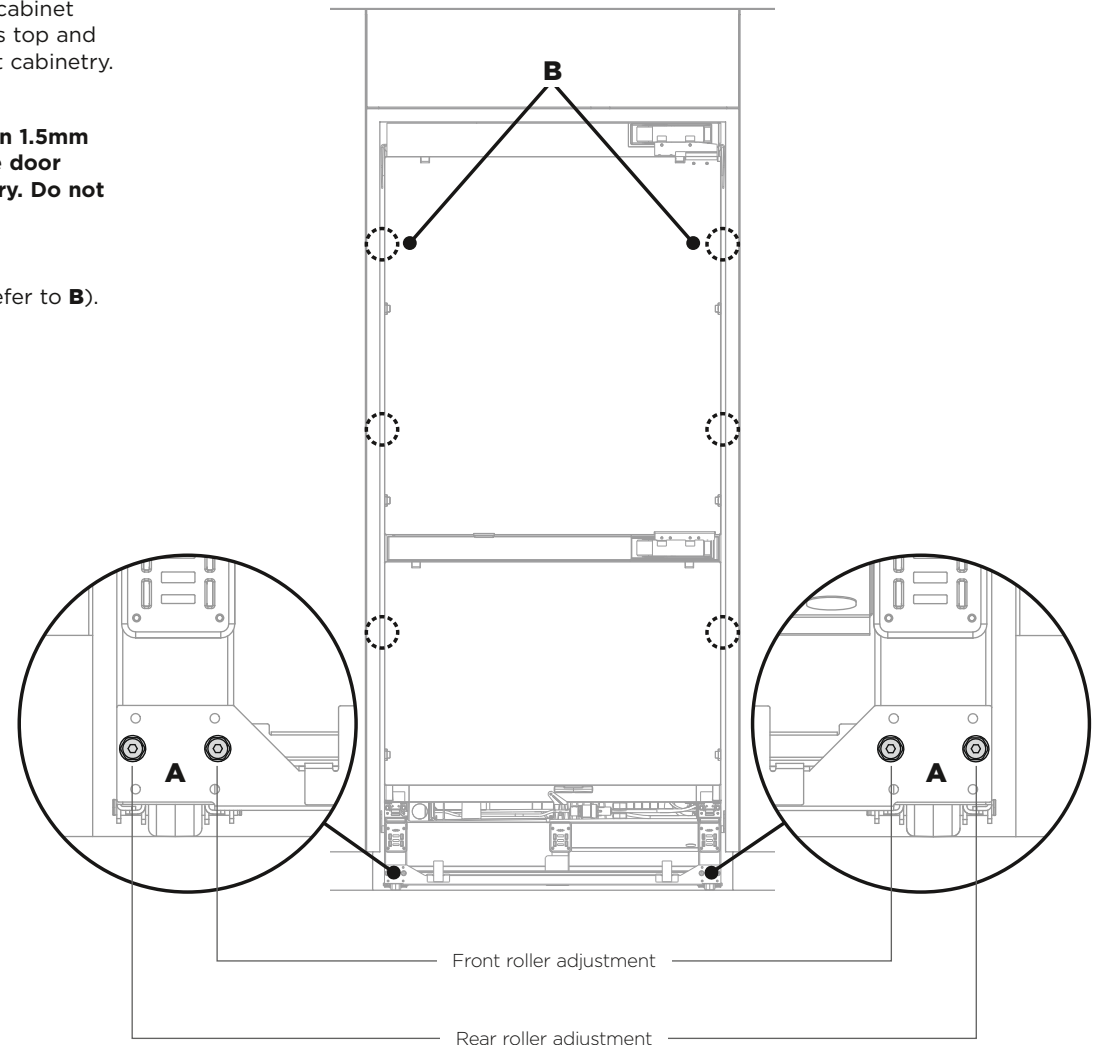
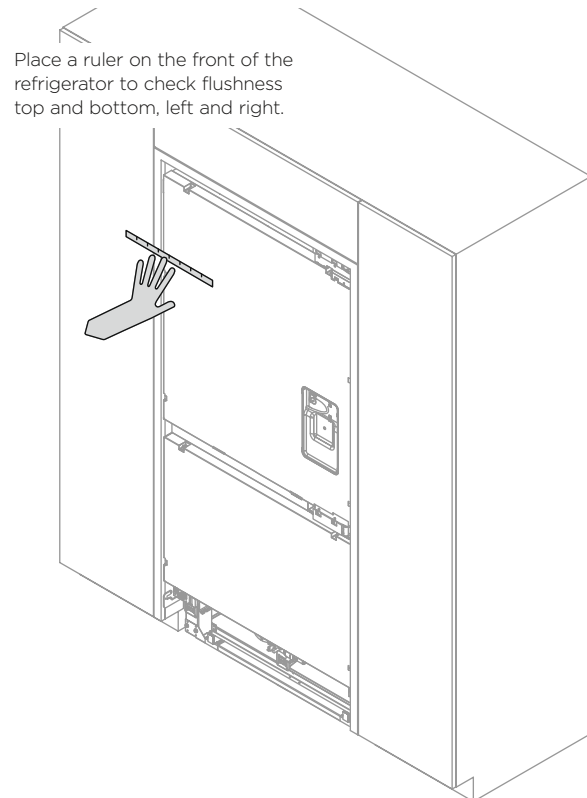

12 INSTALL WATER FILTER CARTRIDGE AND KICKSTRIPS

IMPORTANT!

- The water filter head must be firmly pushed into the refrigerator and secured, incorrect installation can lead to water leaks.
- It is not necessary to shut off the water supply when installing the water filter.

- ① Remove the red protective cap on the spigot head and align the filter cartridge tool over the filter handle.

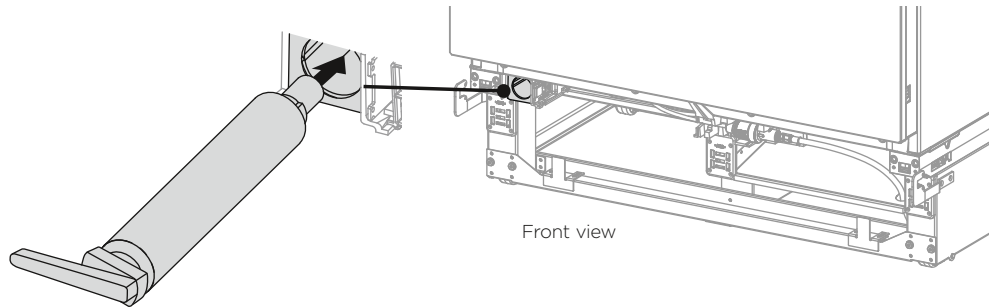

- ② Pull the freezer drawer out slightly and insert the filter cartridge and tool into the bottom left of the refrigerator. Firmly push the cartridge in until the filter head cannot be pushed any further.

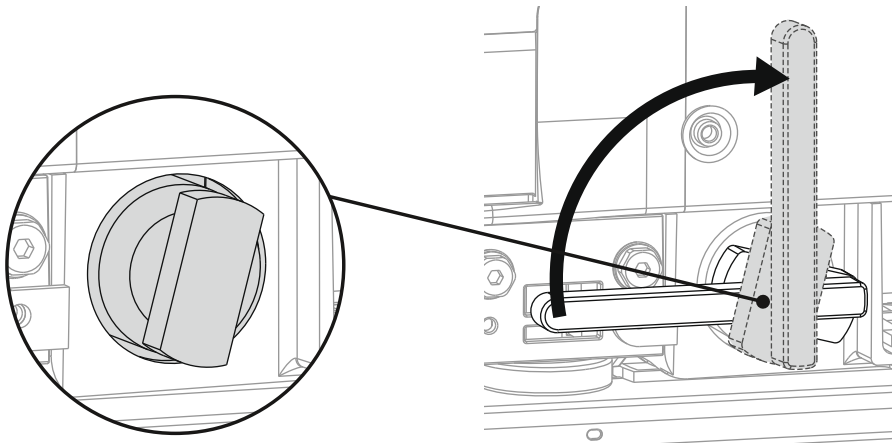

Filter cartridge in the locked position.

- ③ Turn 90° clockwise to tighten. Remove filter cartridge tool and close freezer drawer.

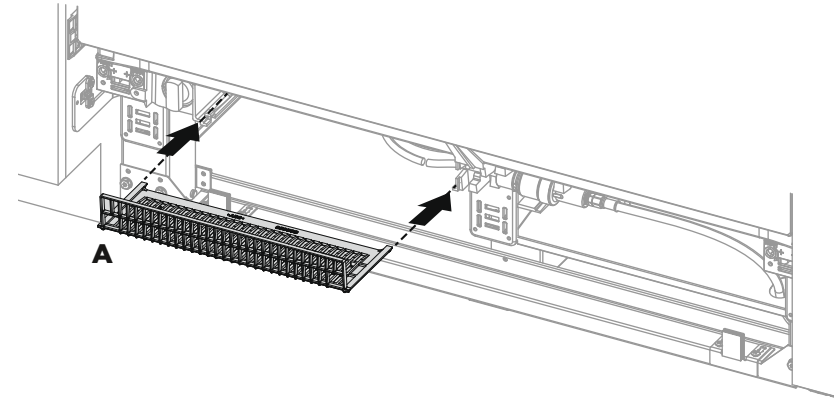

- ④ **Installing kickstrip filter**

Remove filter from inside the refrigerator. Fit the filter onto the rails and push to the rear until it clips securely (refer to **A**).

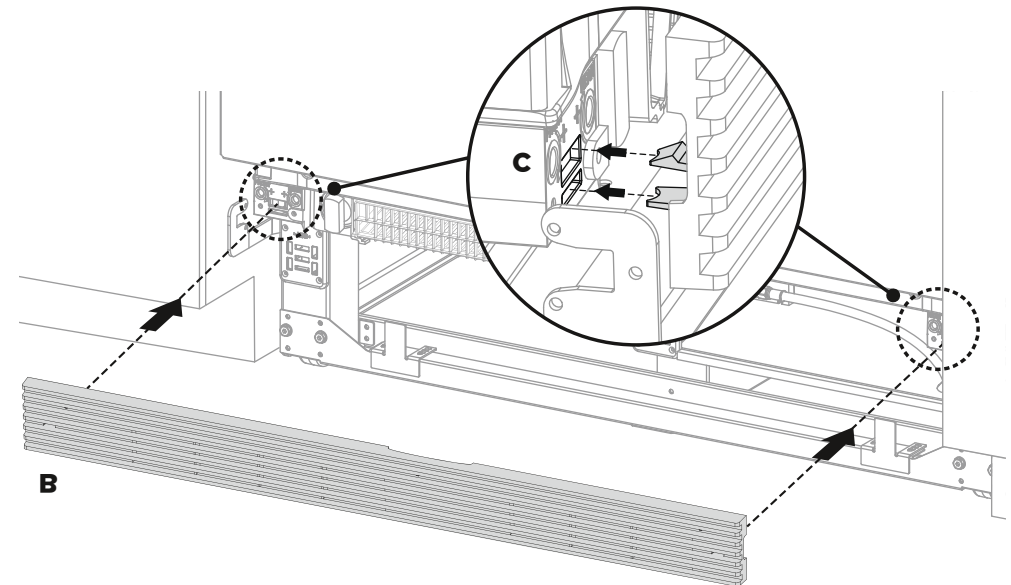

- ⑤ **Top kickstrip grille**

Ensure the top grille is inserted in the correct orientation (refer to **B**). Align the top grille clips to the top plinth slots then firmly push grille onto refrigerator until the clips engage (refer to **C**).

The assembly of Fisher & Paykel (EZKleen stainless steel) door panels and custom door panels are outlined below. To protect the finish of the Fisher & Paykel EZKleen stainless steel door panels, leave the protective film on the panels when hanging and remove the film only when the installation is complete.

If using custom door panels, ensure they are prepared as per 'Custom door panel dimensions' section.

Door panel

① Mounting handle (refer to **A**)

For Fisher & Paykel door panel sets, remove the plastic plugs from the handle holes x4. Align the handle to the holes and secure with screw handle x4 (M5 x 25 pan head socket screws).

For custom panels, ensure handle is secured 65mm from the inner edge of the panel to the centre – this will avoid interference with bracket installation.

② Hanging bracket (refer to **B**)

For Fisher & Paykel door panel sets, align the bracket to the holes and secure with screws x6 (M5 x 14 Mush Phillips SS).

For custom panels, secure bracket with screws x6 (#8 x 16 Mush washer screws).

③ Side brackets and straps (refer to **C**)

For Fisher & Paykel door panel sets, align bracket and strap to the holes on the side of the panel and secure with screws x2 (M5 x 14 Mush Phillips SS).

For custom panels, secure bracket with screws x2 (#8 x 16 Mush washer screws).

Repeat this process for all brackets and straps.

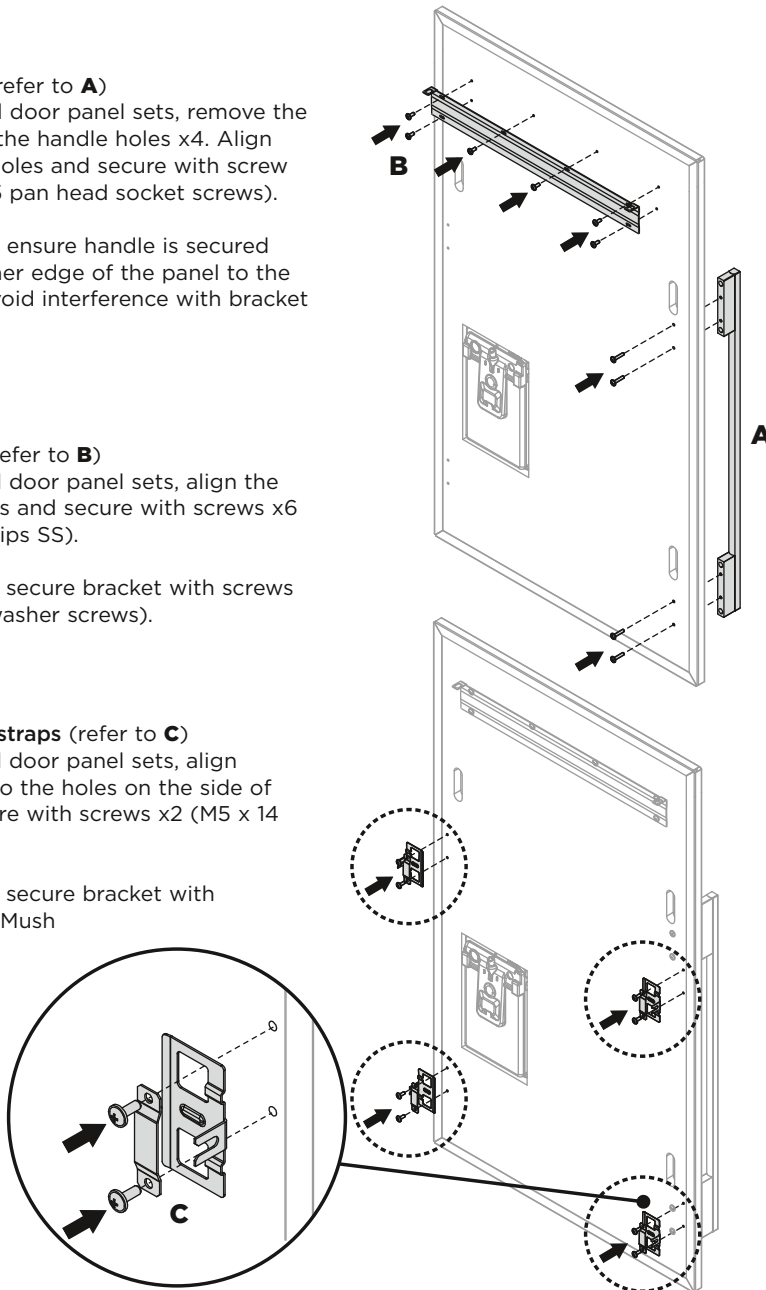

Drawer door panel

④ Mounting handle (refer to **D**)

For Fisher & Paykel door panel sets, remove the plastic plugs from the handle holes x4. Align the handle to the holes and secure with screw handle x4 (M5 x 25 pan head socket screws).

For custom panels, ensure handle screw heads are counter sunk into the back of the panel to avoid interference with hanging bracket.

⑤ Hanging bracket (refer to **E**)

For Fisher & Paykel door panel sets, align the bracket to the holes and secure with screws x6 (M5 x 14 Mush Phillips SS).

For custom panels, secure bracket with screws x6 (#8 x 16 Mush washer screws).

⑥ Side brackets and straps (refer to **F**)

For Fisher & Paykel door panel sets, align bracket and strap to the holes on the side of the panel and secure with screws x2 (M5 x 14 Mush Phillips SS).

For custom panels, secure bracket with screws x2 (#8 x 16 Mush washer screws).

Repeat this process for all brackets and straps.

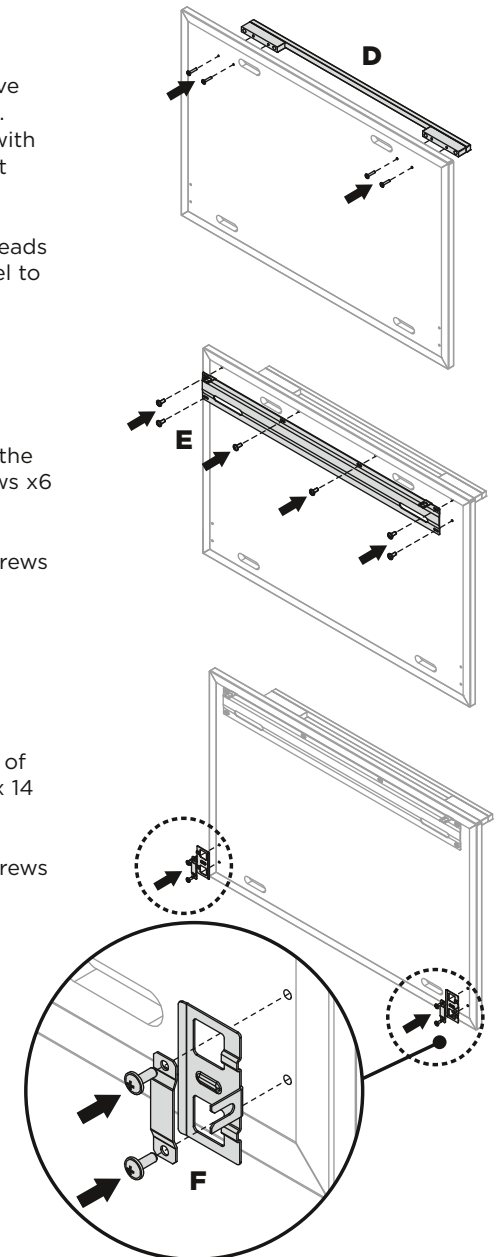

For Fisher & Paykel EZKleen stainless steel door panels only.

- ① Remove the external display module from inside the refrigerator.

Thread the display harness through the door panel cavity. Ensure the grommet is engaged.

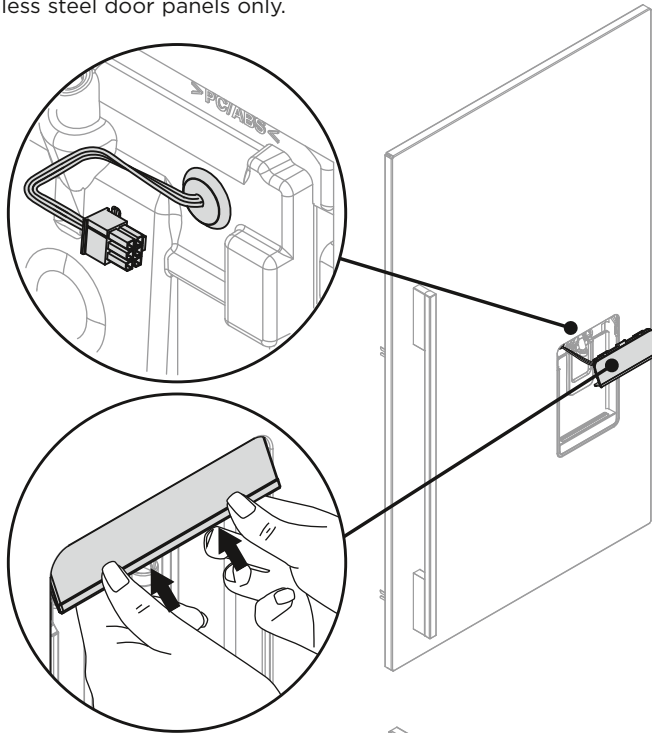

- ② Angle top display tabs into the door panel. Ensure the harness is free of pinching. Firmly push against bottom display tabs and insert into the door panel until you feel it clip securely. Ensure the display is flush with the door panel.

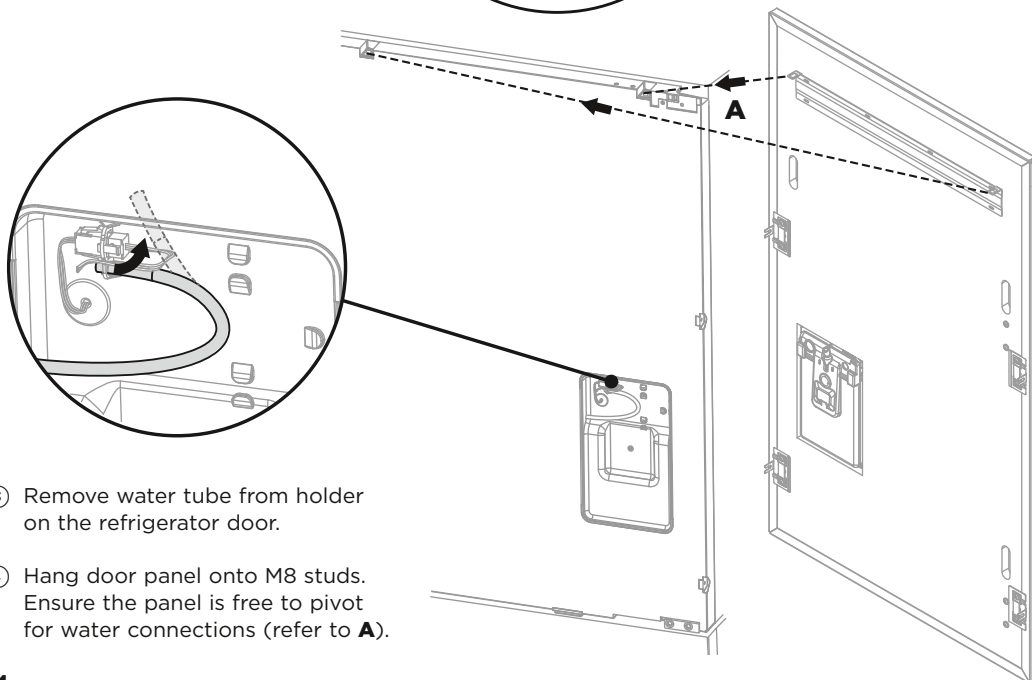

- ③ Remove water tube from holder on the refrigerator door.
- ④ Hang door panel onto M8 studs. Ensure the panel is free to pivot for water connections (refer to **A**).

- ⑤ Connect display harness onto the refrigerator door by inserting firmly until you feel it clip securely (refer to **B**).

On the external display, enable the dispenser lock, this will help prevent any water from dispensing during water connection. To lock, press the **6** button for 4 seconds. The LED above the button will illuminate.

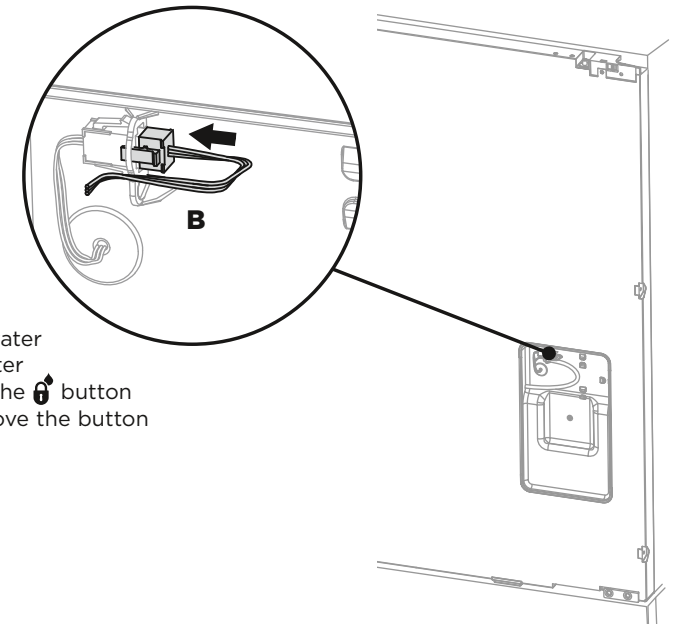

- ⑥ Firmly push the water tube into the spigot behind the door panel until the marked line is not visible.

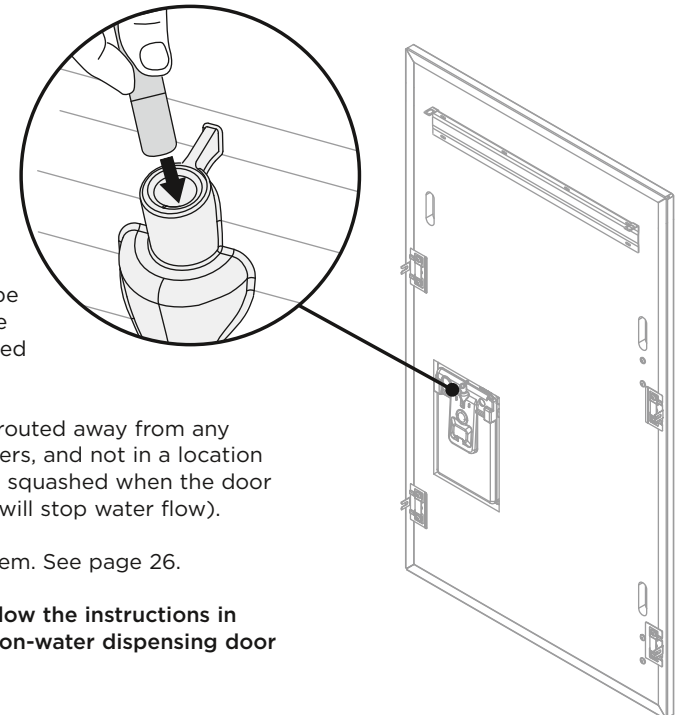

Ensure the water tube is routed away from any sharp objects, sharp corners, and not in a location where it can be kinked or squashed when the door panel is secured, (as this will stop water flow).

Flush water filtration system. See page 26.

To secure door panel, follow the instructions in the next section: 'Hang non-water dispensing door panels'.

For Fisher & Paykel EZKleen stainless steel door panels and custom panels.

IMPORTANT!

Remove protective film from white refrigerator doors before hanging door panels.

- ① Hang all door panels onto M8 studs and align the side bracket forks onto the refrigerator door.
 - Ensure the forks are positioned around the body of the side screws (M5 x 10 pan head Phillips screw).
- ② Push the refrigerator until the door panels are flush. Depending on your installation design this will be flush with your adjacent cabinetry or your framework. Place a ruler on the front of the refrigerator to check flushness top and bottom, left and right (refer to drawing below).
- ③ Ensure the gap between the top of the door panel and the top cabinetry is no greater than 7mm. To reduce this gap, raise the refrigerator by turning all four adjustment nuts the same number of turns.

IMPORTANT!

Failure to follow these steps can lead to difficulties in door panel adjustment and cosmetic cap fitment.

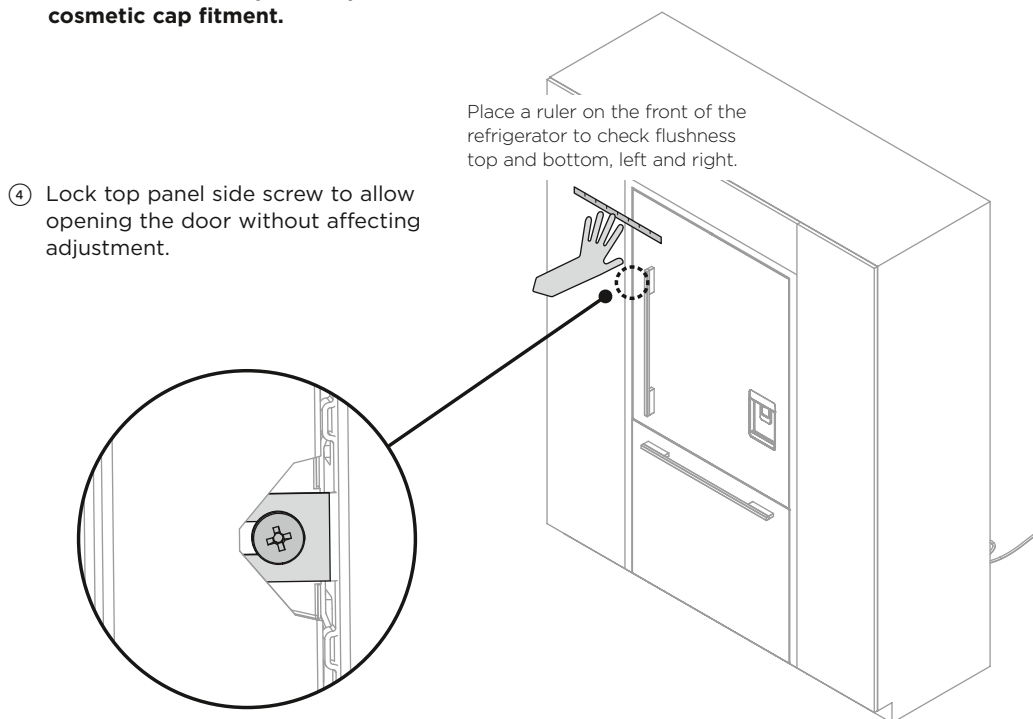

- ⑤ All door panels have full axis adjustment to ensure they are flush with adjacent walls. To adjust the height of each panel turn clockwise to raise stud or counter-clockwise to lower stud (refer to **A**).

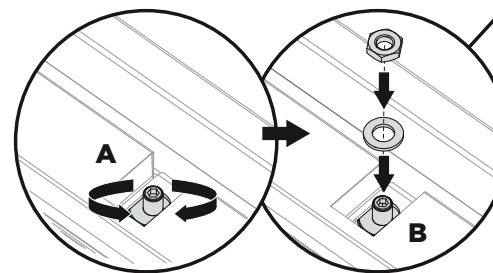

- ⑥ Once satisfied with all door panels, secure M8 studs with M8 washer and M8 nut (refer to **B**). The top of the stud must remain below the top face of the door panel.

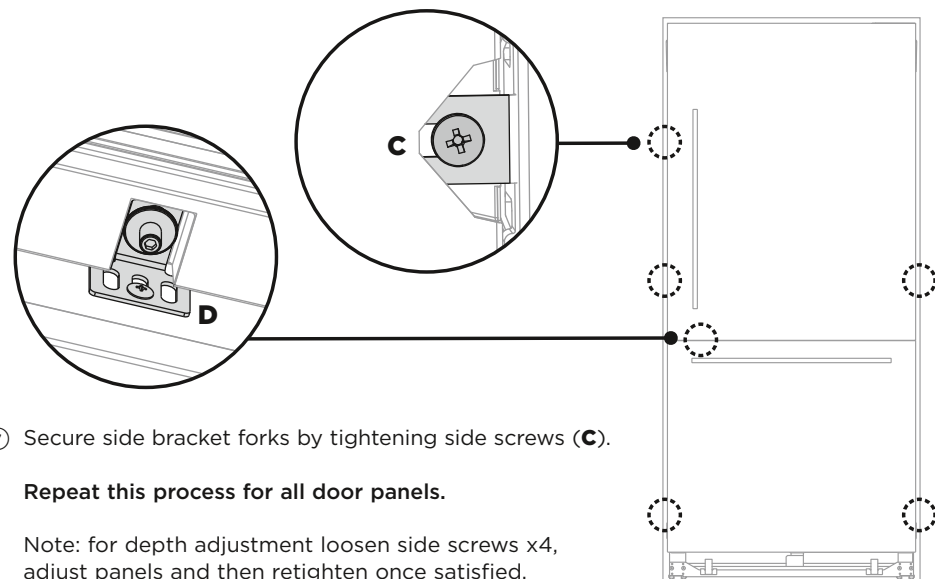

- ⑦ Secure side bracket forks by tightening side screws (**C**).

Repeat this process for all door panels.

Note: for depth adjustment loosen side screws x4, adjust panels and then retighten once satisfied.



Note: further adjustment of door panels can be achieved by removing door panels then loosening the fixing screws for the hanging bracket and moving the bracket sideways to suit.

- ⑧ Loosely install locking bracket into the pocket on the underside of the door using a M8 stud (**D**). Slide the locking bracket out until it touches the back of the door panel. Screw in place using a #8 x 16 screw through one of the three slotted holes. Fully tighten the M8 stud.

Now it is time to carry out the ice and water initiation to ensure you are free of leaks before fully installing the product. Ensure the appliance is switched on and the isolation tap has been connected and turned on.

Ice maker initiation

To initiate ice maker before use:

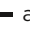
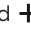
- After initial setup of your refrigerator, the ice maker is off by default.
- To activate the automatic ice maker, press the 'Ice On/Off'  button once. The LED light above the  button will illuminate indicating the ice maker is on.
- Press and hold the ,  and  together for 4 seconds then close the doors. The ice tray will flip twice and empty the water into the bin below. The ice tray will flip only after the doors are closed.
- Repeat the ice maker cycle. This helps remove any manufacturing and transportation dust in the ice tray.
- Empty the water, dry and return the bin. Ensure that the scoop is located at the front of the bin.
- Once the ice maker is in operation, discard the ice made for the first 24 hours. This will flush away any impurities in the water line.

For more information on making ice please refer to the User Guide supplied with this appliance.

Water dispenser initiation (Ice & Water models only)

To flush the water filtration system before use:

- Press the water dispenser pad to dispense water for 2 minutes.
 - Wait for 2 minutes before dispensing again.
- Dispense 4L of water and then wait for another 2 minutes.
 - Take notice of carbon residue that may be dispensed together with water. This is not harmful, and normal during flushing process.
- Dispense another 4L of water.
 - This prevents excessive dripping of water from your dispenser.
- Water will drip from the dispenser for a few more days after installation to clear remaining trapped air in the dispenser.
- Ensure your refrigerator has cooled for at least 2 hours before use



Water dispenser

IMPORTANT!

Do not dispense water continuously for more than 2 minutes at a time.

For more information on water dispensing please refer to the User guide supplied with this appliance.

17 ATTACH FIXING BRACKETS

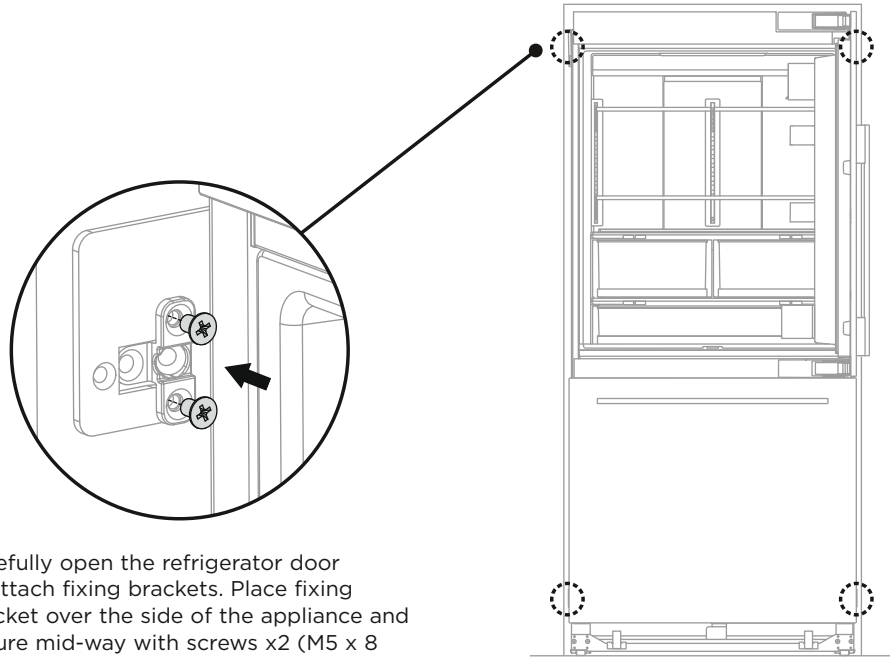

- ① Carefully open the refrigerator door to attach fixing brackets. Place fixing bracket over the side of the appliance and secure mid-way with screws x2 (M5 x 8 countersunk Phillips screws).

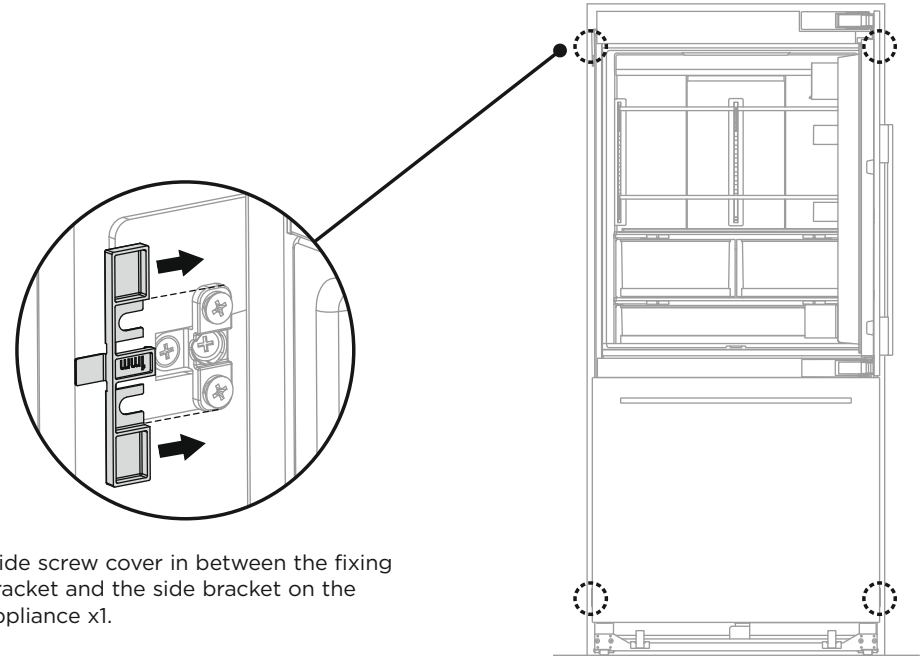

- ③ Slide screw cover in between the fixing bracket and the side bracket on the appliance x1.

Repeat this process for the remaining screw covers.

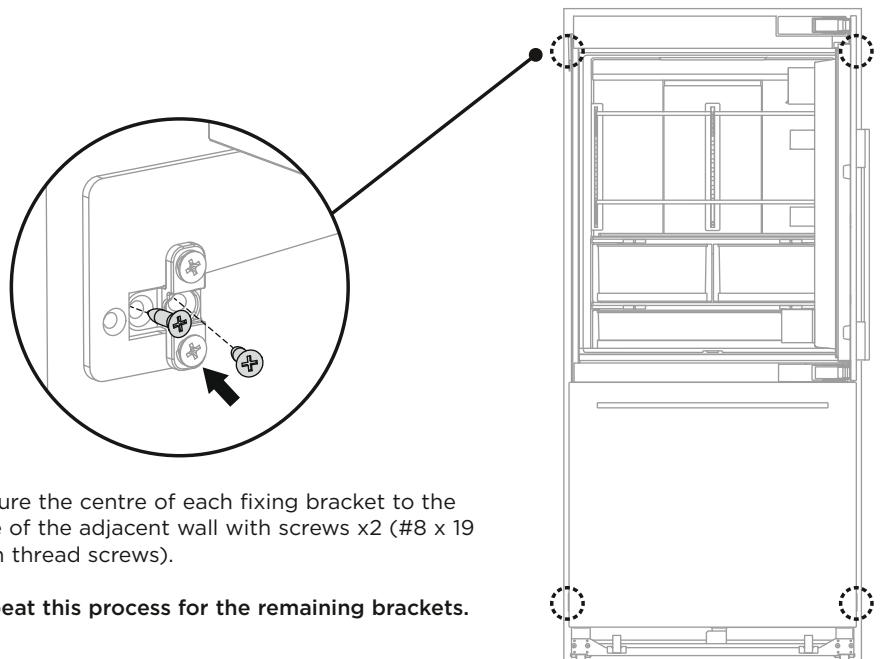

- ② Secure the centre of each fixing bracket to the side of the adjacent wall with screws x2 (#8 x 19 twin thread screws).

Repeat this process for the remaining brackets.

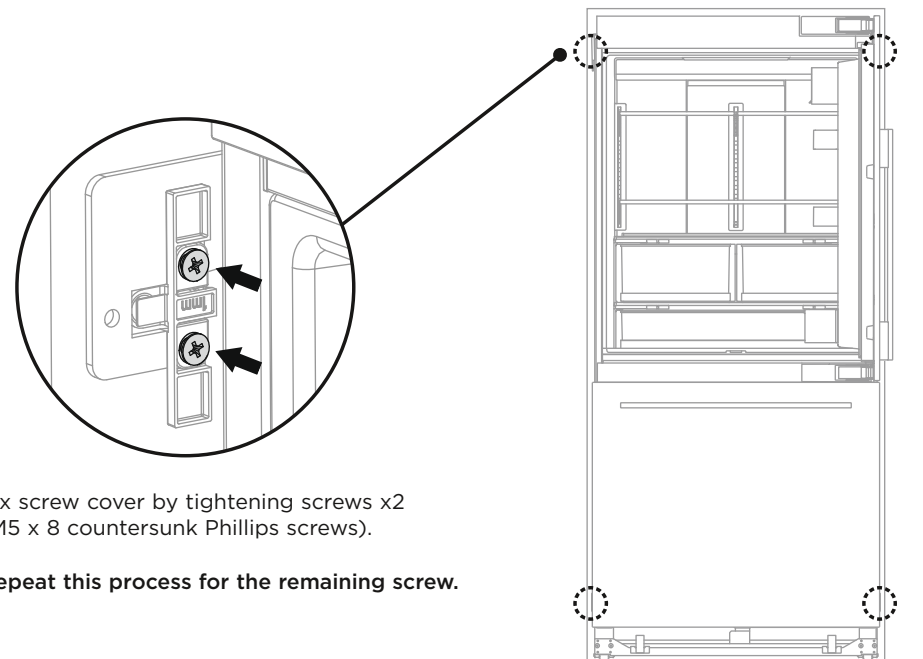

- ④ Fix screw cover by tightening screws x2 (M5 x 8 countersunk Phillips screws).

Repeat this process for the remaining screw.

18 ATTACH COVERS

- ① If applicable, remove any remaining protective film on your door panels.

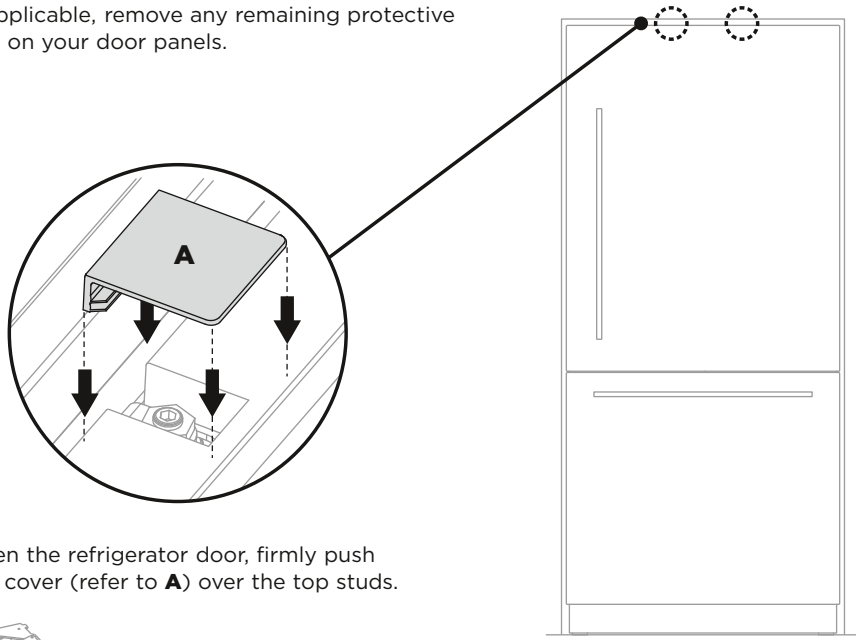

- ② Open the refrigerator door, firmly push top cover (refer to **A**) over the top studs.

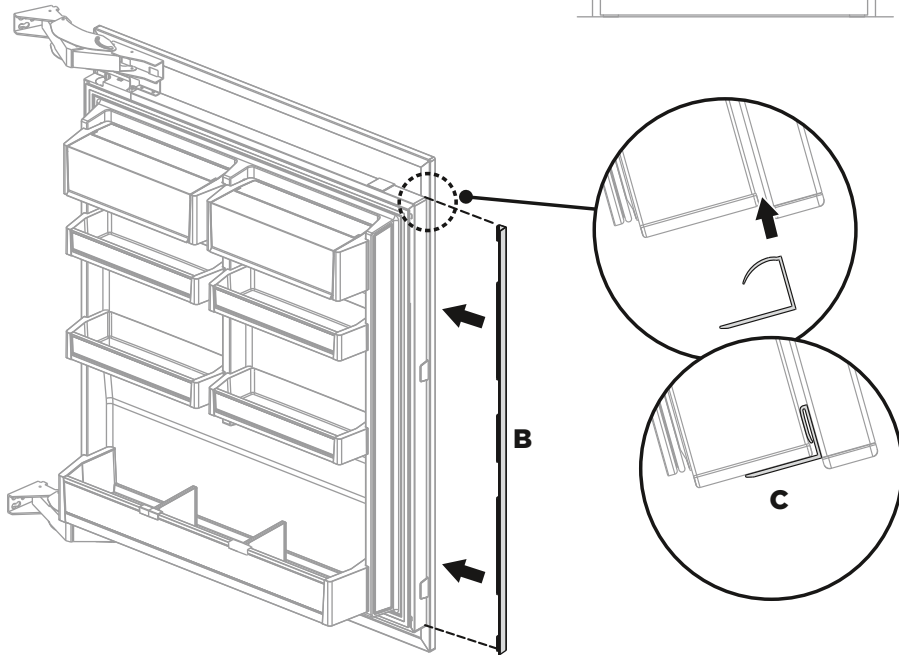

- ③ **Door side trims**
Install the side trims by inserting into the panel gaps on each side of the door (refer to **B**). Align the trim to the top of the door and press evenly into the panel gap until fully seated (refer to **C**).

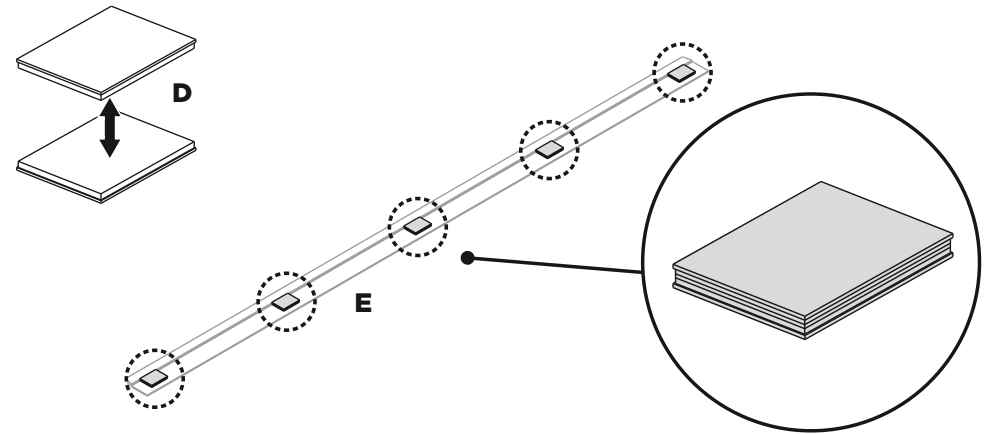

- ④ Press the 3M Dual Lock™ tabs together to form pairs (refer to **D**) and remove the adhesive backing on one side only.

Press firmly to install on the underside of the drawer top trim in the indicated locations (refer to **E**).

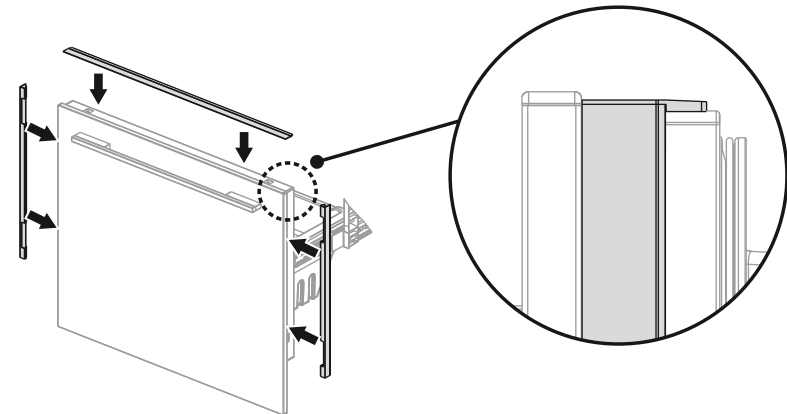

- ⑤ **Drawer side trims**
Install the side trims in the same manner (refer to step ③).

- ⑥ **Drawer top trim**
Remove the remaining adhesive backing from the 3M Dual Lock™ tabs. Locate the trim against the back surface of the panel and press down firmly. Ensure the trim is fully seated against the drawer surface.

19 ATTACH TOE KICK

The standard appliance includes a stainless steel toe kick (102mm) and the hardware required to mount the toe kick (102mm). Alternatively, the customer can supply their own toe kick (102 – 152mm) for complete integration of the refrigerator.

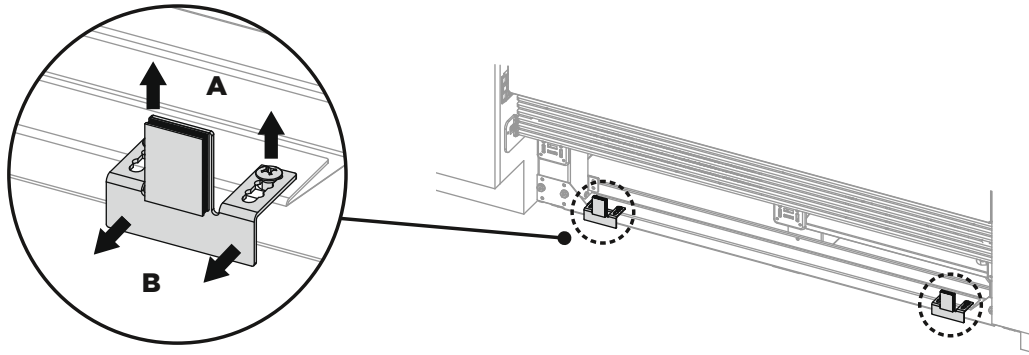

① Installing toe kick

Unscrew the toe kick bracket screws mid-way, and bring forward (refer to **A** and **B**).

Repeat this process on the opposite side.

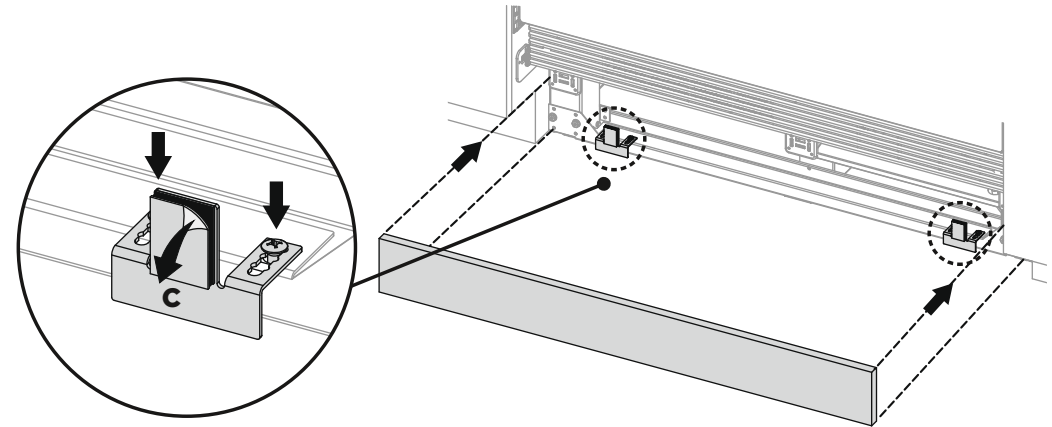

② Place toe kick in front of the brackets and gently push towards the refrigerator until flush with surrounding cabinetry. Once satisfied, remove the toe kick.

③ Tighten the toe kick bracket screws to lock brackets into position and remove the backing from the Velcro strip (refer to **C**). Attach toe kick to the adhesive surface.

For custom toe tick greater than 102mm

- ① Measure the required height for the bottom grille. On a board, carefully score/cut the un-required vanes from the bottom of the kickstrip grille and discard (refer to **A**).
- ② Drill Ø 4mm holes into the dimples of the grille (refer to **B**).

Repeat this process for all dimples.

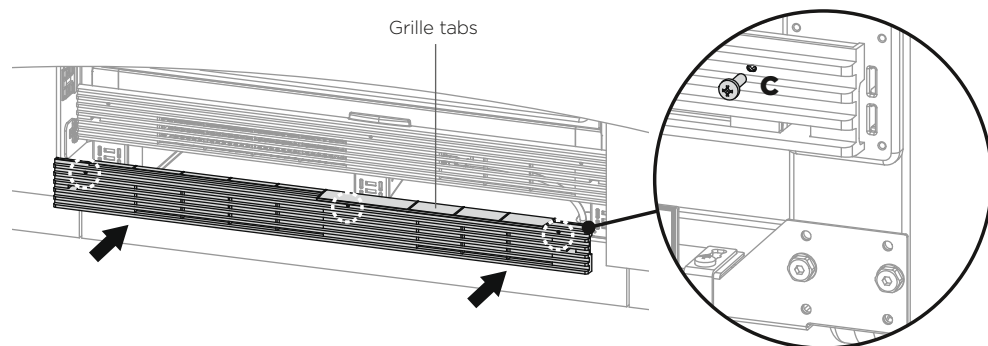
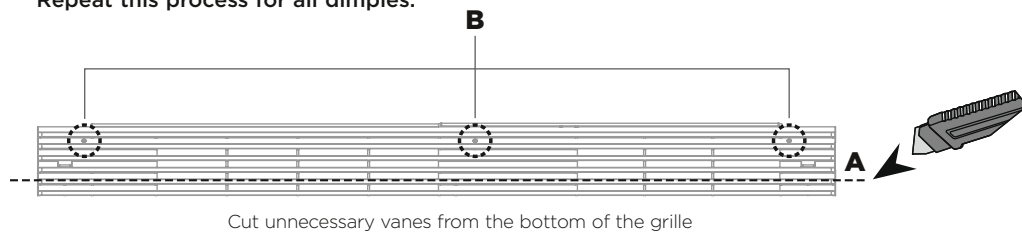

- ③ With the grille tabs facing upwards, align the grille to the bottom of the plinth where the screw holes are located and secure with screws x3 (#8 x 16mm pan head screws) (refer to **C**).
- ④ Align the air flow divider underneath the grille tabs indicator and clip onto the vanes of the bottom grille (refer to **D**).

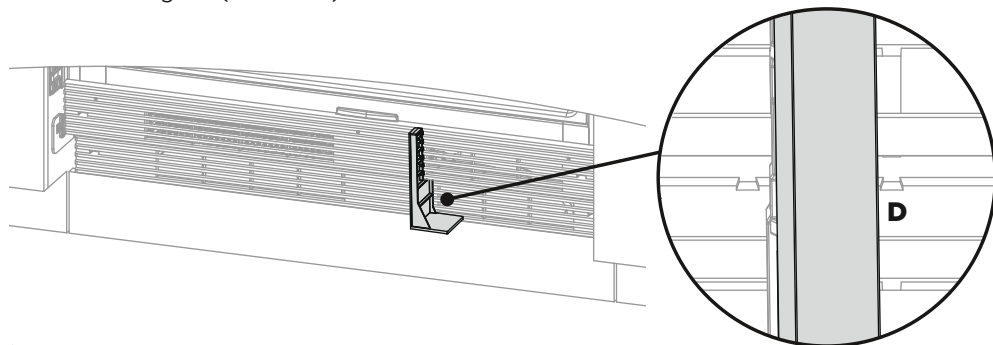
**For toe kick installation at 102mm**

- ① With the grille tabs facing upwards, align the grille clips to the bottom of the plinth's slots, then firmly push grille onto the plinth (refer to **A**).

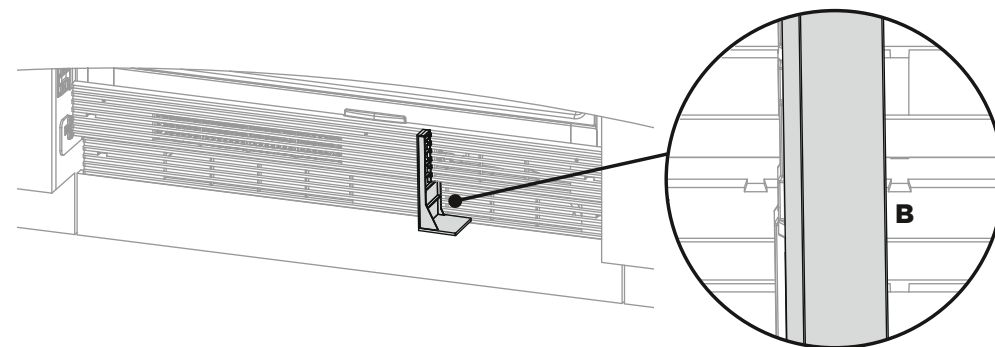
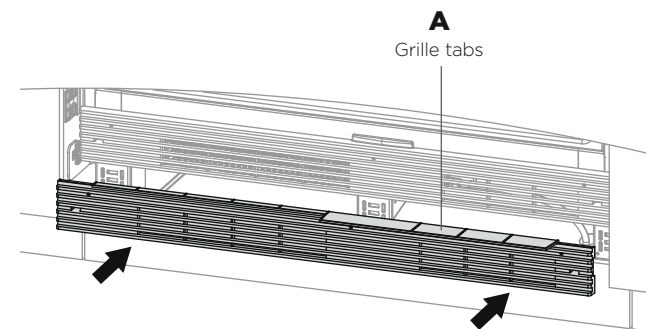

- ② Align the air flow divider underneath the grille tabs indicator and clip onto the vanes of the bottom grille (refer to **B**).

TWO METHODS ARE AVAILABLE FOR ATTACHING SIDE TRIM BRACKETS:

(A) FLEXIBLE SPRING CLIP METHOD - RECOMMENDED METHOD (B) FIXED SCREW METHOD - METHOD TO USE IF CABINET IS NOT TO SPECIFICATION

(Attempt method A. If method A results in poor fitment of side trims due to cabinetry that is uneven or out of specification, use method B).

21 ATTACH SIDE TRIM BRACKETS - (A) FLEXIBLE SPRING CLIP METHOD

IMPORTANT!

Before installing your refrigerator, ensure the dimensions of the finished enclosure are correct for your refrigerator following the 'Product and cavity dimensions' sections.

- ① Break off the datum lip to each side trim bracket and discard.

Repeat for all side trim brackets.

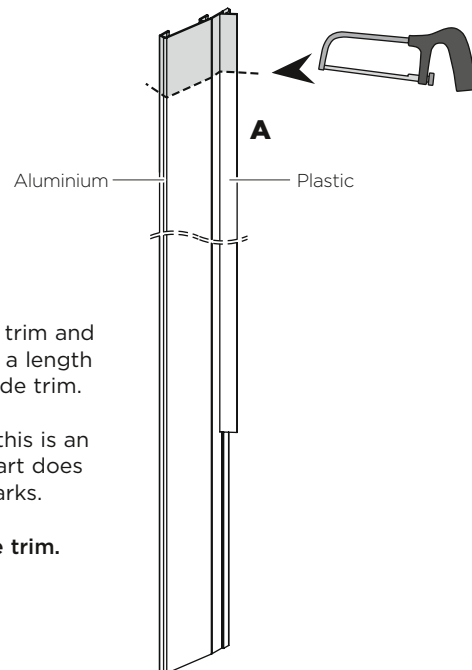
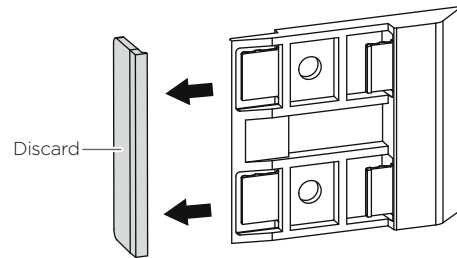

For 2032 mm cavity installation only

- ② Measure 102mm from the top, shorter side trim and carefully cut using a fine tooth hacksaw to a length of 1930mm. Refer to A for orientation of side trim.

Note: ensure cut is straight and square as this is an exposed surface. Also ensure the plastic part does not bend as this can cause visual stress marks.

Repeat this process for the remaining side trim.

- ③ Position 3 side trim brackets onto each side trim.

Note: measure from the top of the trim, with the shorter lip at the bottom. (Refer to B for 2032mm and 2134mm bracket locations and trim orientation).

IMPORTANT!

Each bracket has two engagement points for the side trim to locate. Ensure the trim is engaged in both points (refer to C).

Repeat this process for the remaining side trim.

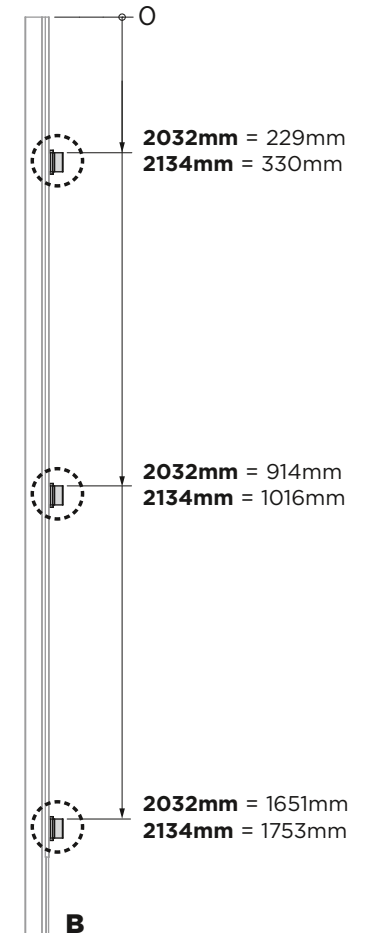
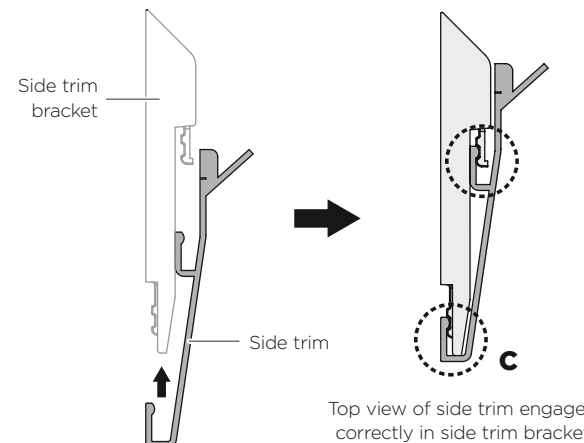

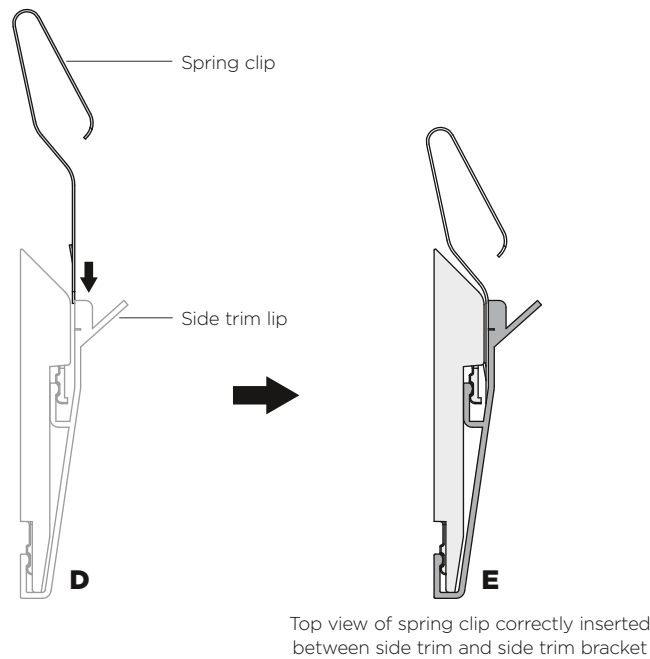

- ④ Insert the spring clip into the gap between the side trim and side trim bracket, orientation as shown in figures **D** and **E**.

IMPORTANT!

Ensure spring clip is correctly oriented with the open loop facing the side trim lip.

Repeat this process for the remaining side trim.

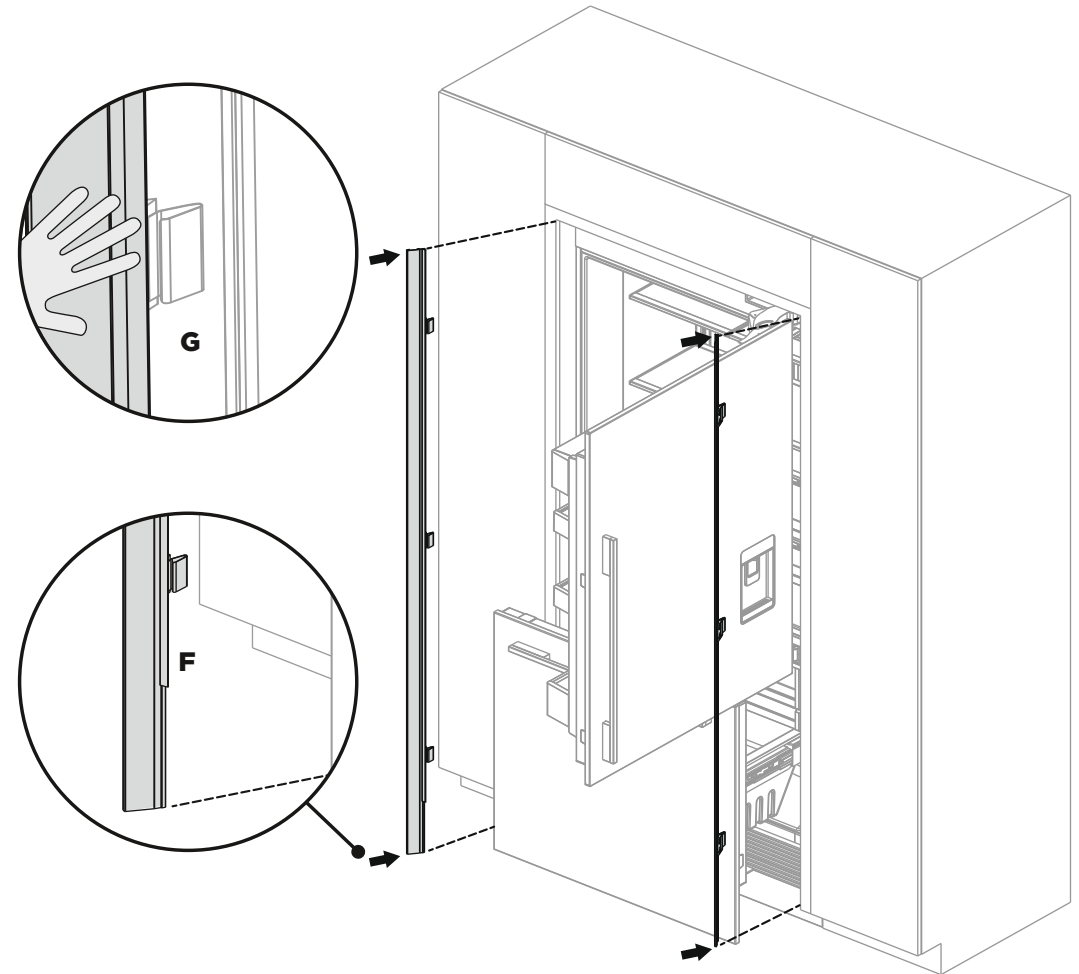

- ⑤ Open refrigerator door. Place the assembled side trim with brackets and spring clips against the alcove side wall with the shorter lip facing the bottom (refer to **F**).

IMPORTANT!

Ensure the side trim is positioned as high as it will go.

Push the side trim at each bracket location until there are no visible gaps between the trim and cabinetry (refer to **G**).

Repeat this process for the remaining side trim.

21 ATTACH SIDE TRIM BRACKETS - (B) FIXED SCREW METHOD

If method A has resulted in poor fitment of side trims due to cabinet being out of spec, use method B.

IMPORTANT!

Before installing your appliance, ensure the dimensions of the finished enclosure are correct for your appliance following the 'Product and cavity dimensions' sections.

- ① Break off the datum lip to each side trim bracket and discard.

Repeat for all side trim brackets.

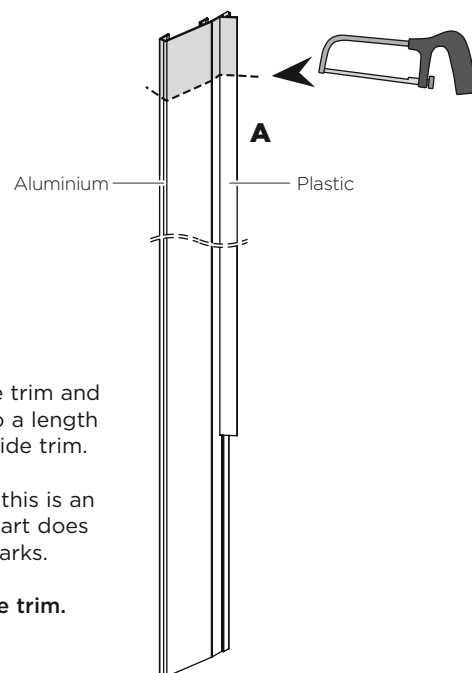
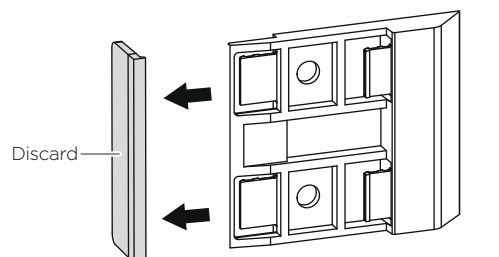

For 2032mm cavity installation only

- ② Measure 102mm from the top, shorter side trim and carefully cut using a fine tooth hacksaw to a length of 1930mm. Refer to **A** for orientation of side trim.

Note: ensure cut is straight and square as this is an exposed surface. Also ensure the plastic part does not bend as this can cause visual stress marks.

Repeat this process for the remaining side trim.

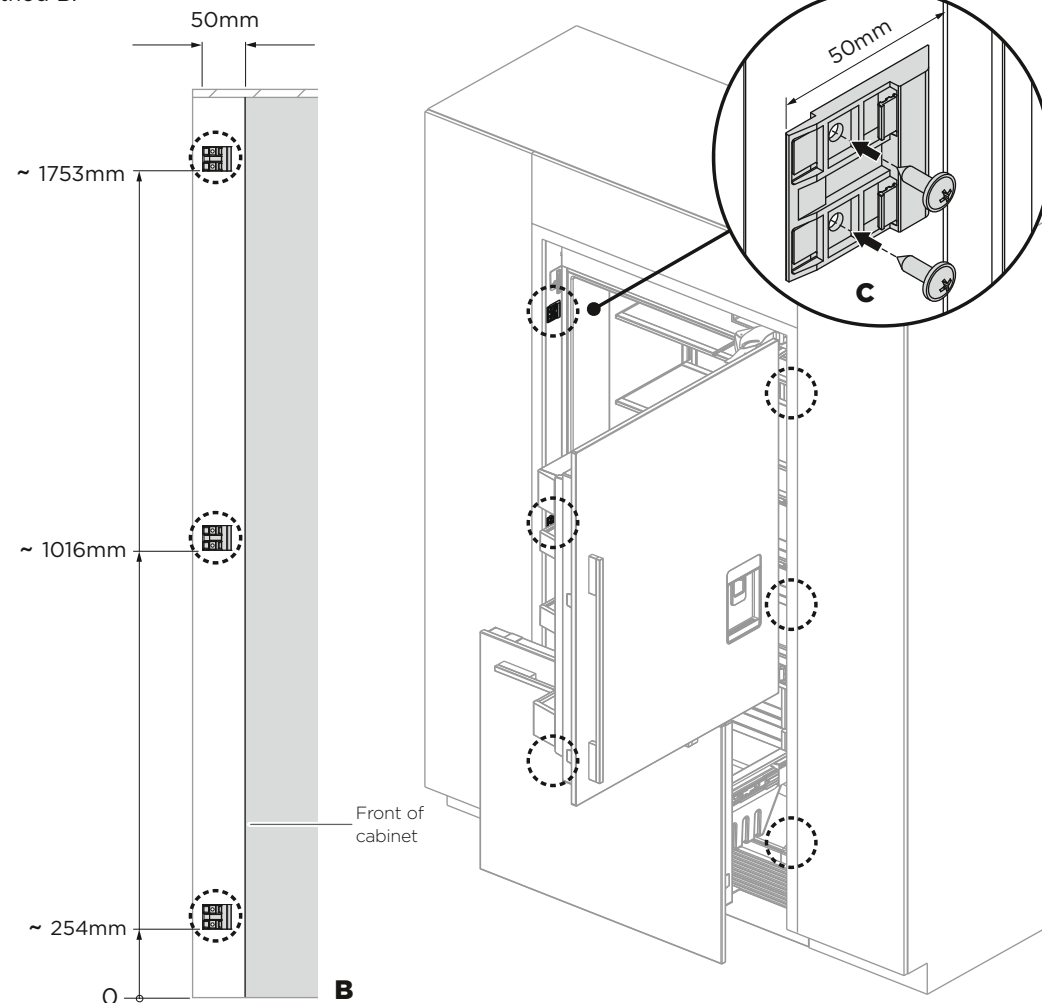

- ③ Position three side trim brackets on each side (refer to **B** for bracket locations). Open the appliance door. Measure 50mm from the front of refrigerator (from behind the door), to the front of the alcove and accurately mark a vertical line (refer to **C**).

Align the bracket edge with the marked line and using screws x2 (#8 x 16 mush washer) fix the bracket to the cabinetry x3.

Repeat on the opposite side.

IMPORTANT!

Inaccurate positioning of bracket can result in inability to fit side trim or gaps between side trim and appliance.

- ④ Place the side trim against the alcove side wall with the shorter lip facing the bottom (refer to **D**).
- Ensure the side trim is positioned as high as it will go.
 - Engage the side trim with the brackets by pushing the trim inwards at the locations of the top and middle side trim brackets. Once the trim has engaged with top and middle brackets, then push and engage the side trim at the location of the bottom bracket (refer to **E**).

IMPORTANT!

- **Ensure there are no visual gaps between the refrigerator and side trims.**
- **Each bracket has two engagement points for the trim to locate. Ensure the trim is engaged at both points (refer to **F**).**

Repeat this process for the remaining side trim.

Correct visual gaps by loosening side trim screws and moving trim within clearance. If further adjustment is required, relocate brackets to desired position.

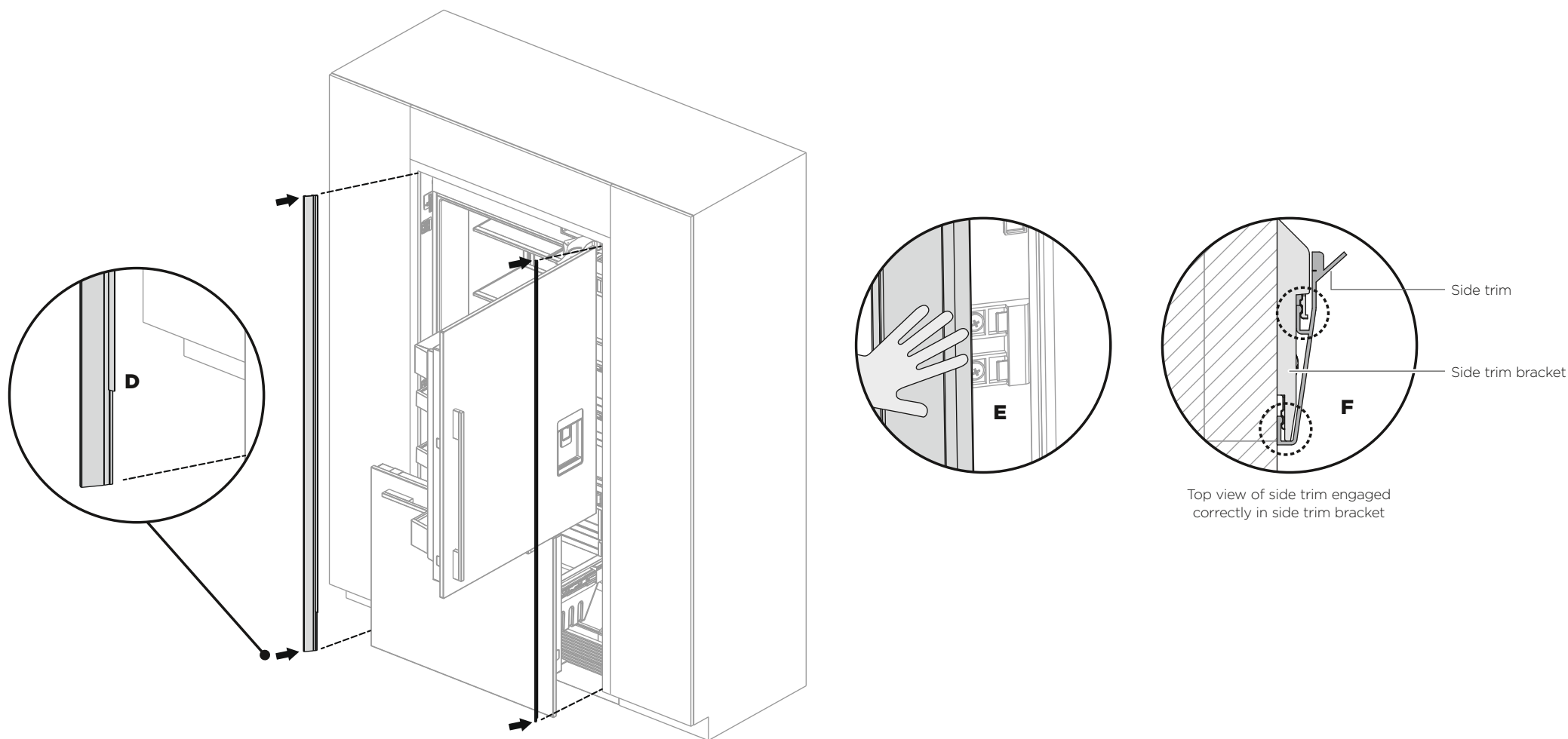

Hinge tensioning screws can be tightened if increased door closing force is required.

- ① To tighten the screw, hold the door open at 90 degrees, and rotate the screw clockwise until it has moved sideways from position 0 to position 1, and then continue tightening until the screw has fully bottomed out.

Repeat this process on bottom hinge tensioning screw.

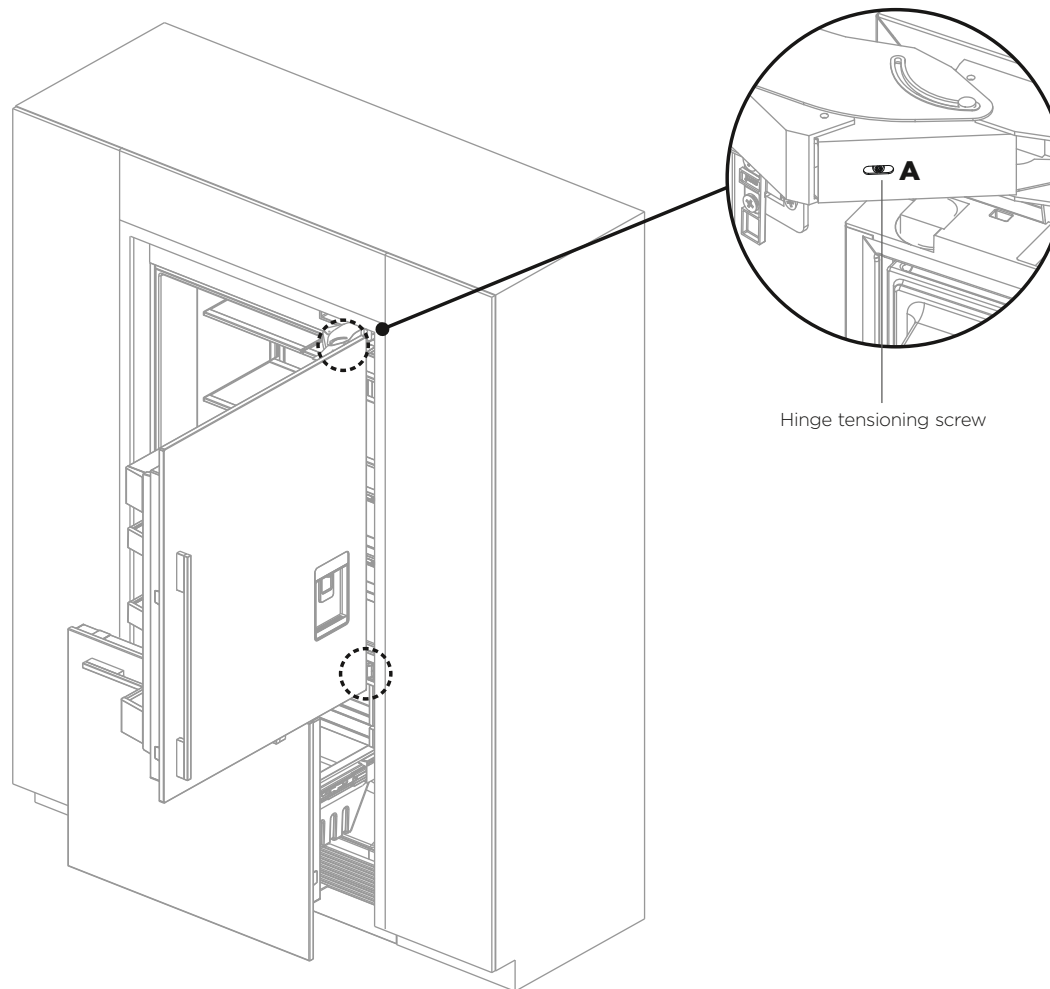

**TO BE COMPLETED BY THE INSTALLER****All models**

- ☐ Check all parts are installed.
- ☐ Ensure the appliance is level.
- ☐ Ensure the appliance is securely fastened to the cabinetry with the supplied anti-tip bracket and fittings.
- ☐ Ensure the door/drawer can open and close freely with no resistance from surrounding cabinetry.
- ☐ Ensure hinge limiting pin is fitted for 90° door swing.
- ☐ Ensure all internal and external packaging is removed from the appliance before use.
- ☐ Ensure a manual ice maker cycle has been forced.

Ice & Water models only

- ☐ Ensure the water filtration system has been flushed.

Complete and keep for safe reference:

Model	_____
Serial No.	_____
Purchase Date	_____
Purchaser	_____
Dealer Address	_____
Installer's Name	_____
Installer's Signature	_____
Installation Company	_____
Installation Date	_____

FISHERPAYKEL.COM

© Fisher & Paykel Appliances 2017. All rights reserved.
The product specifications in this booklet apply to the specific products and models described at the date of issue. Under our policy of continuous product improvement, these specifications may change at any time. You should therefore check with your Dealer to ensure this booklet correctly describes the product currently available.

NZ AU GB IE HK SG IN

846806 A 07.17